

Mi Alegría
Siempre Creativa

#1715



13 en 1 KIT SOLAR ROBÓTICA

Equipo para armar 14 robots diferentes

INSTRUCTIVO



◊ 14 Robots Solares ◊ Científico ◊ Divertido ◊ Mecánico ◊ Robótico ◊

Lee tu instructivo antes de comenzar a jugar para obtener mejores resultados;
consérvalo a la mano para futuras referencias.

14 en 1 KIT SOLAR ROBÓTICA

INSTRUCTIVO

Contenido

Introducción	P.1
Herramientas a Necesitar	P.1
Lista de Piezas Mecánicas	P.1
Piezas de Plástico	P.2
Etiquetas A	P.2
Etiquetas B y Bolsas Herméticas	P.3
Tips	P.3

Armado de los Módulos

Armado el Módulo del Cuerpo	P.4
Harmando el Módulo de la Cabeza	P.6
Probando	P.8
Armado el Módulo de la Lianta	P.9
Etiqueta A	P.9
Armado el Módulo del Bote	P.10
Tips	P.12
14 Modos del Robot	P.13

14 en 1 KIT SOLAR RÓBOTICA

Equipo para armar 14 robots diferentes

Introducción:

Este robot solar puede ser transformado en 14 diferentes robots que incluyen una gran cantidad de movimientos graciosos. El niño podrá cambiar de Perro moviendo la cola a Escarabajo corredor, Cangrejo caminante, Surfer, Velocista, Zombi cazador, etc... Este estuche proporciona accesorios únicos y piezas que hacen al robot moverse en tierra y agua.

La energía alternativa está jugando un papel muy importante y en poco tiempo los niños empezarán a aprender los conceptos básicos detrás de estas tecnologías. Afortunadamente, este juguete solar no necesita baterías. El robot se mueve bajo los rayos directos del sol y permiten a los niños crear usando su infinita imaginación.









Herramientas a Necesitar:

Alicates de corte

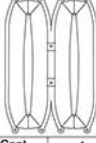

※ Debido a que este juguete contiene muchas piezas, por favor armalas de acuerdo a los pasos indicados en este instructivo. Especialmente pon mucha atención en las marcas "O", "X". Asegúrate que los marcados con "O" son requeridos para armar, de otra manera el robot puede no funcionar de manera normal incluso cuando termines de armarlo.

Lista de Piezas Mecánicas:

P1 & P3 Motor con Conectores		P2 Panel Solar con Resortes					
 	Cant. 1		Cant. 1				
<small>ADVERTENCIA: No conectes los cables a la toma de corriente</small>							
P4 Eje con Engrane		P5 Engrane (Rojo)		P6 Engrane (Verde)		P9 Bote	
	Cant. 1		Cant. 1		Cant. 1		Cant. 1
P7 esponja		P8 Eje Redondo					
	Cant. 2		Cant. 1				

— 1 —

Piezas Plásticas:

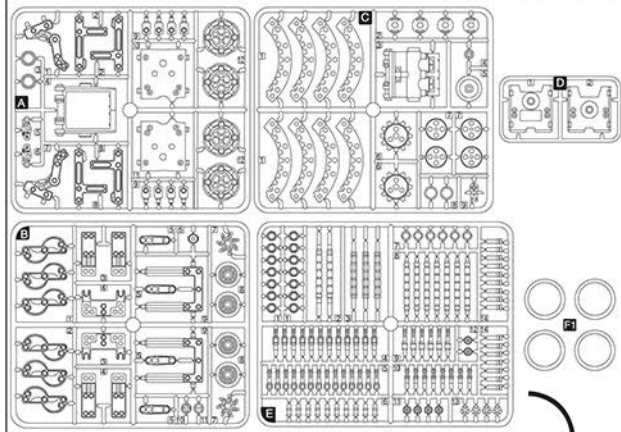

Etiquetas A

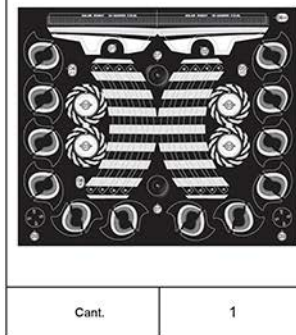

Cant.

1



Asegúrate de cortar las piezas de plástico de la letra E correctamente.

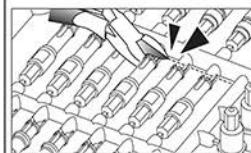

O

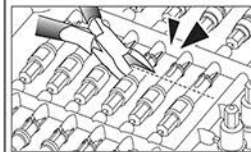

X

— 2 —

Etiquetas B		Bolsas Herméticas	
	Cant.		Cant.
	1		

Tip



Para una ubicación fácil de las piezas de plástico, se sugiere separar las piezas y ponerlas dentro de las bolsas herméticas de acuerdo a las instrucciones.

(A cada bolsa hermética pónle primero una etiqueta ilustrada de las Etiquetas B -como se muestra abajo-)

(Aviso: ¡Cuidado de no perder las piezas pequeñas!)

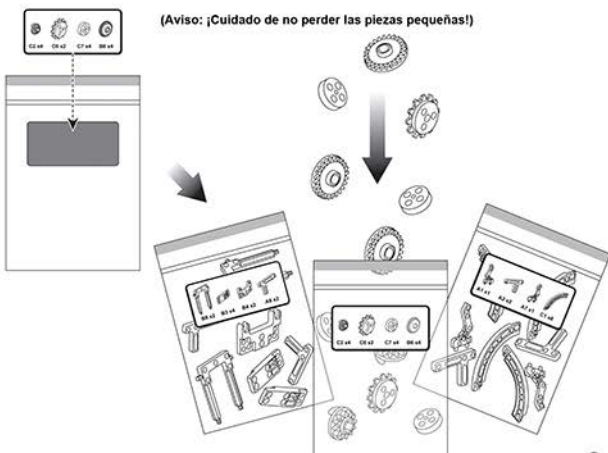

x9

Armado del Módulo del Cuerpo

Módulo completo

B 1

B 2

P5 Rojo

C4

P6 Verde

P4

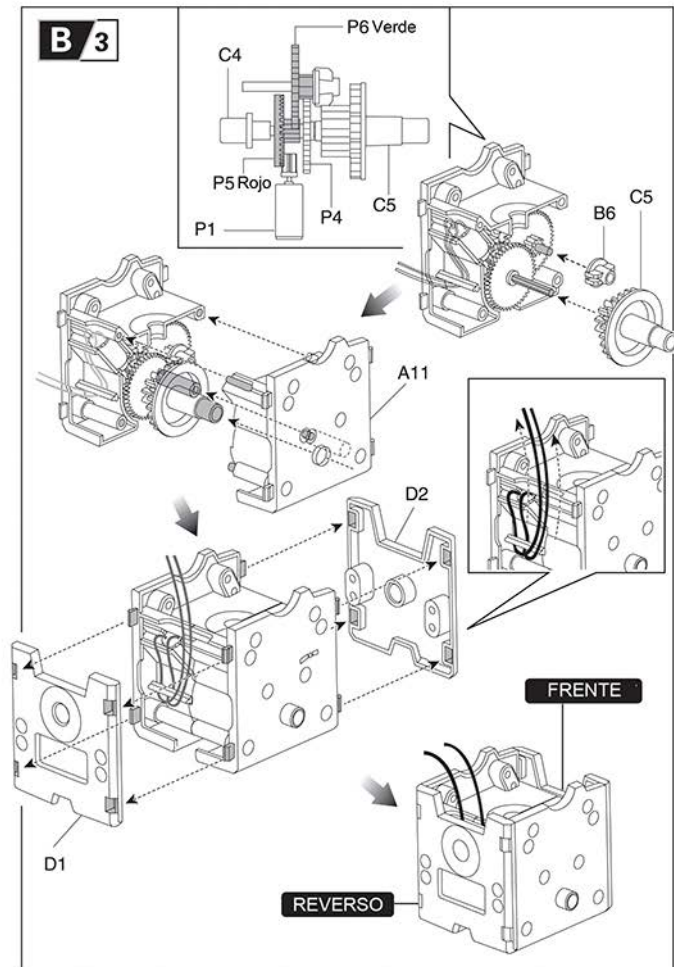
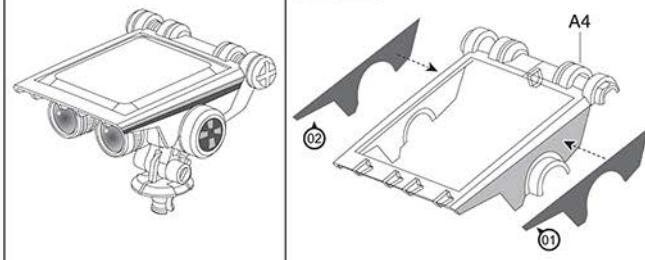
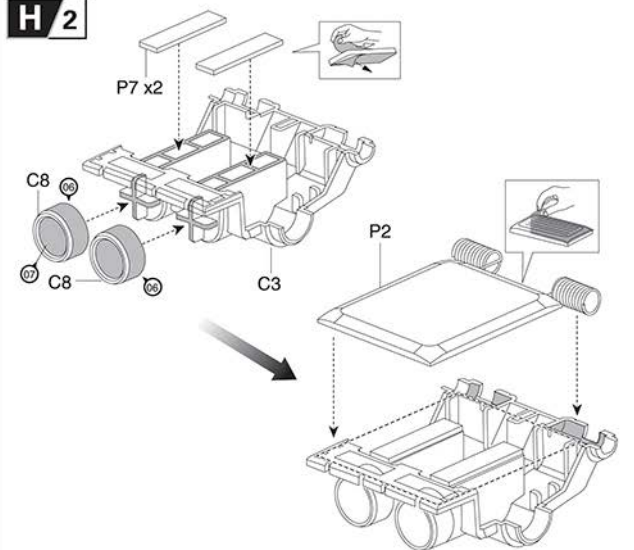
B 3**Armado del Módulo de la Cabeza****Módulo completo****H 1****H 2**

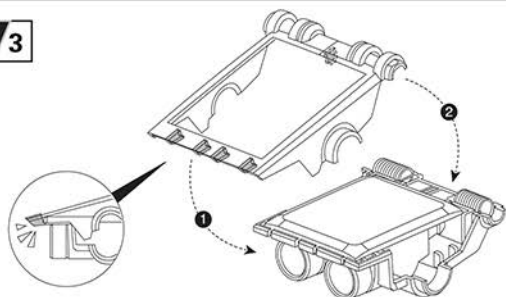
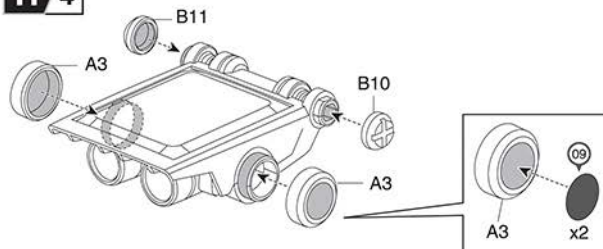
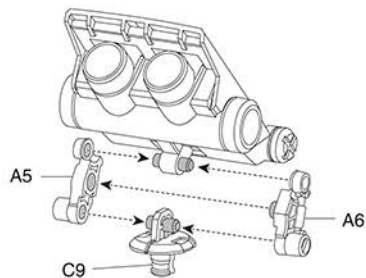
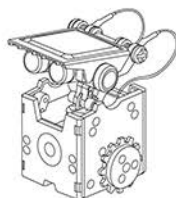
H 3**H 4****H 5****Probando: Necesitas probar la caja de cambios primero.**

Prepara primero las piezas de abajo antes de probar la "Caja de Cambios" y el "Panel Solar".

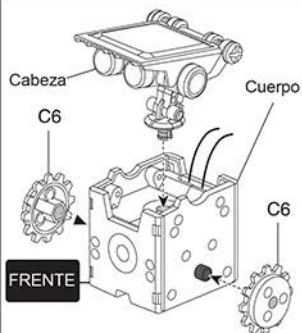
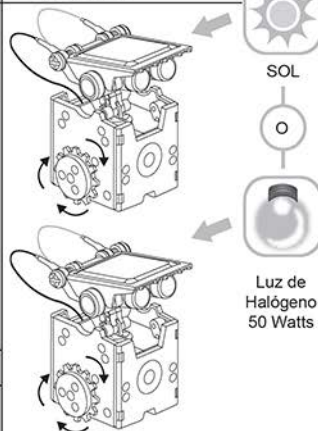
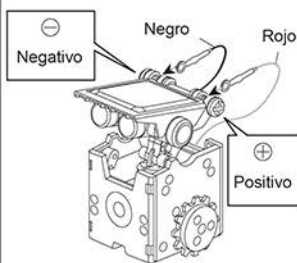
**01 Armado****03 Probando****Cableado**

¡Asegúrate que C6 está encendiendo!

04 Solución de Problemas

Si C6 no funciona, desarma la caja de cambios y vuelve a la página 4

Armado del Módulo de la Lanta

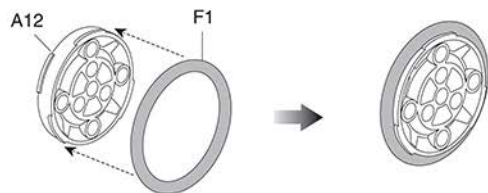

x4

Etiqueta A

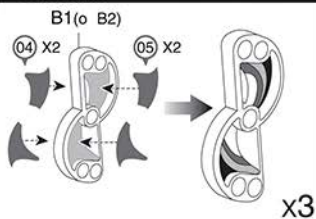

x3

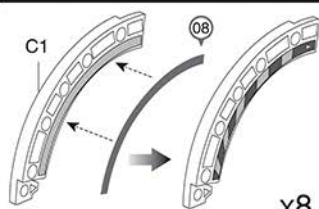

x8

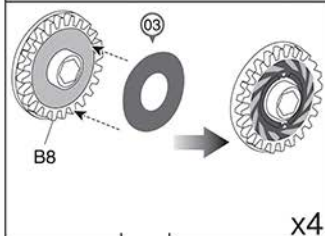

x4

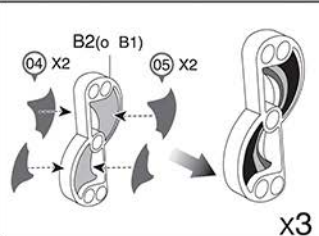

x3

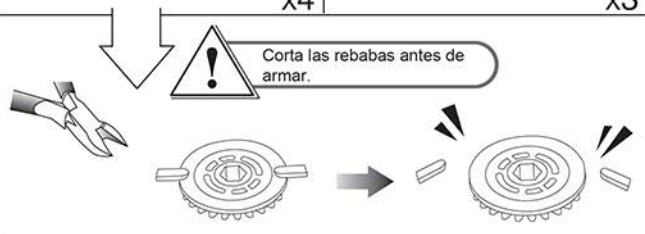

Armado del Módulo del Bote

Forma del bote

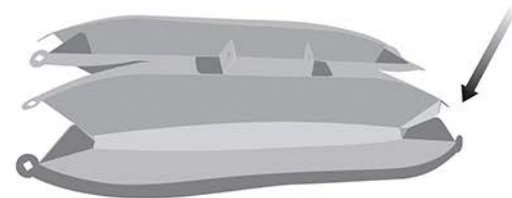
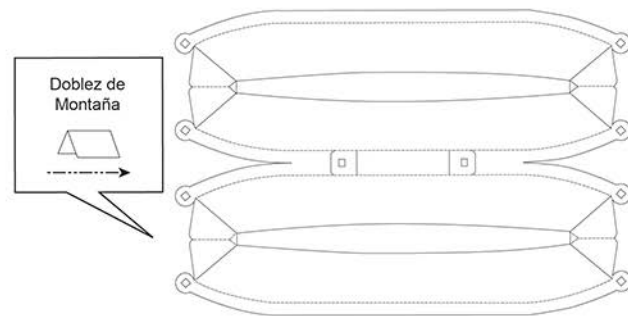
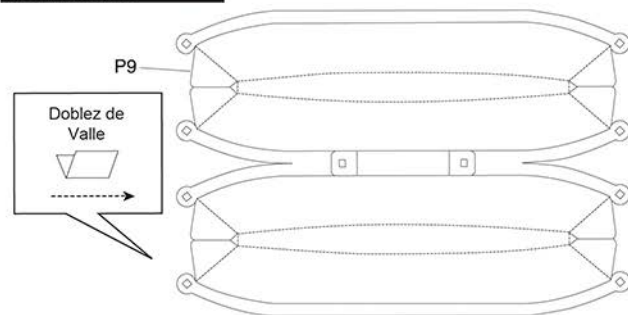

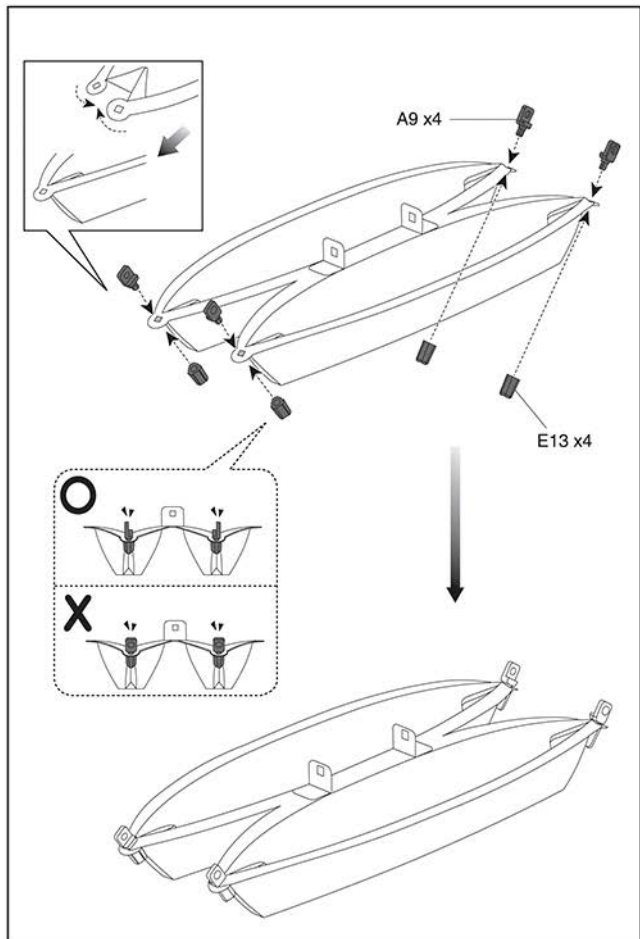

Tips (Cuando tu pieza esté atorada.)

Ejemplo 1

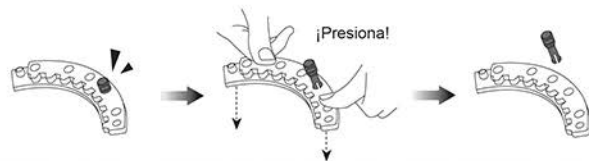

Ejemplo 2

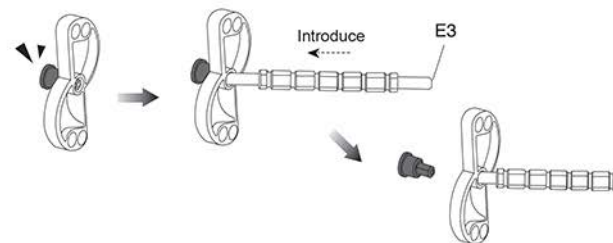

Ejemplo 3

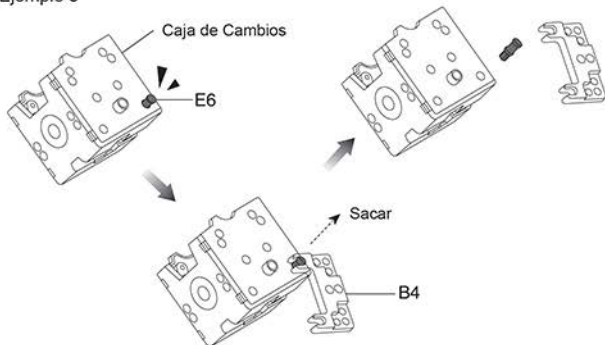

Nivel 1

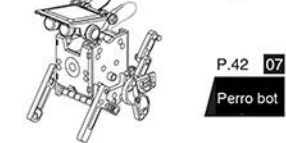
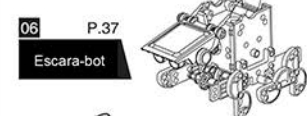
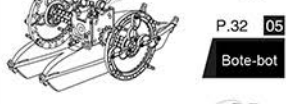

Nivel 2

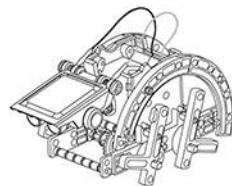
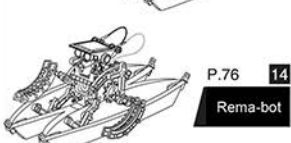
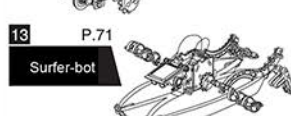
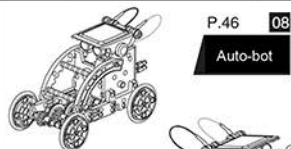

Prepara las partes de abajo antes de armar la "Tortuga-bot".

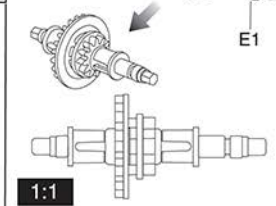
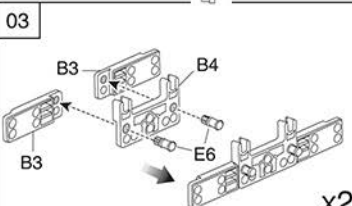
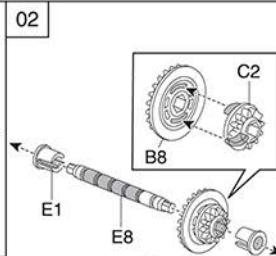
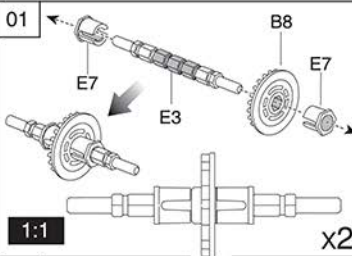

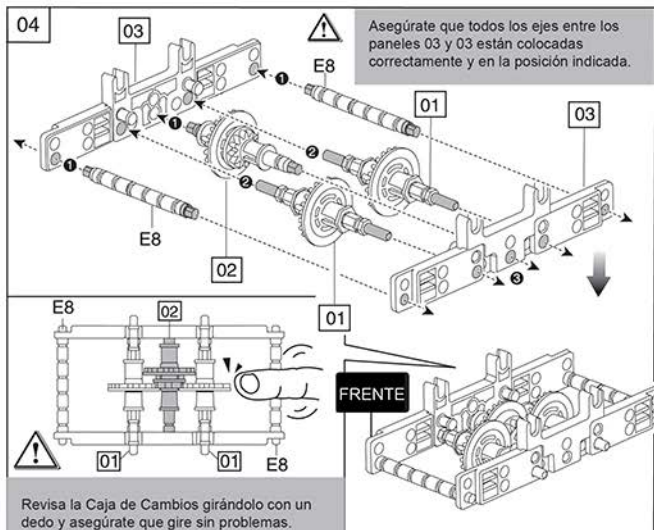

Revisa la Caja de Cambios girándolo con un dedo y asegúrate que gire sin problemas.

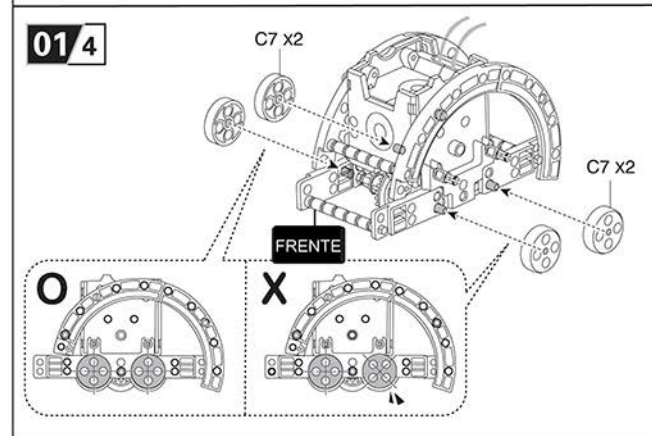
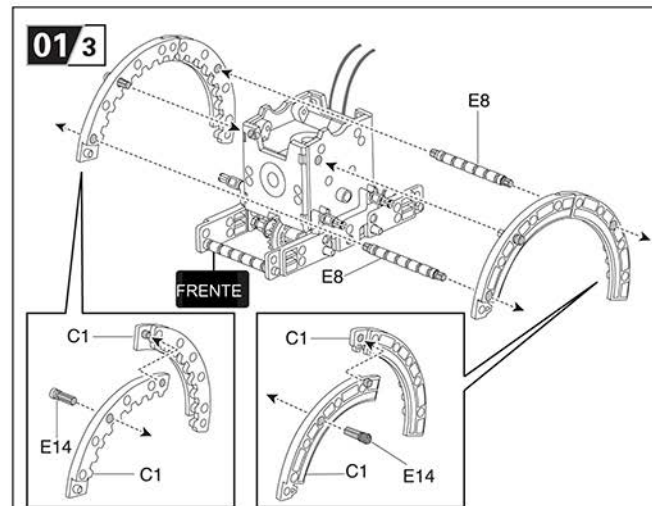
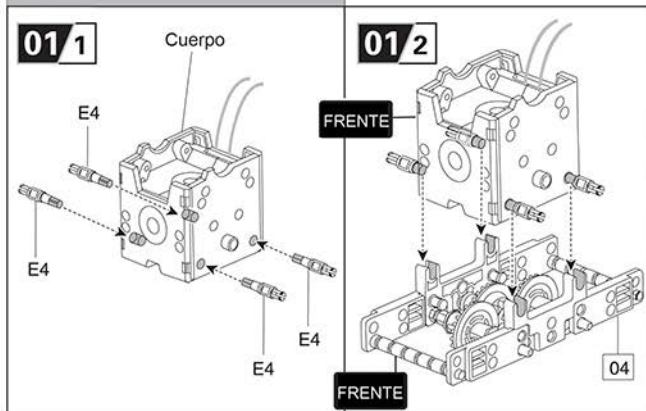

01/5

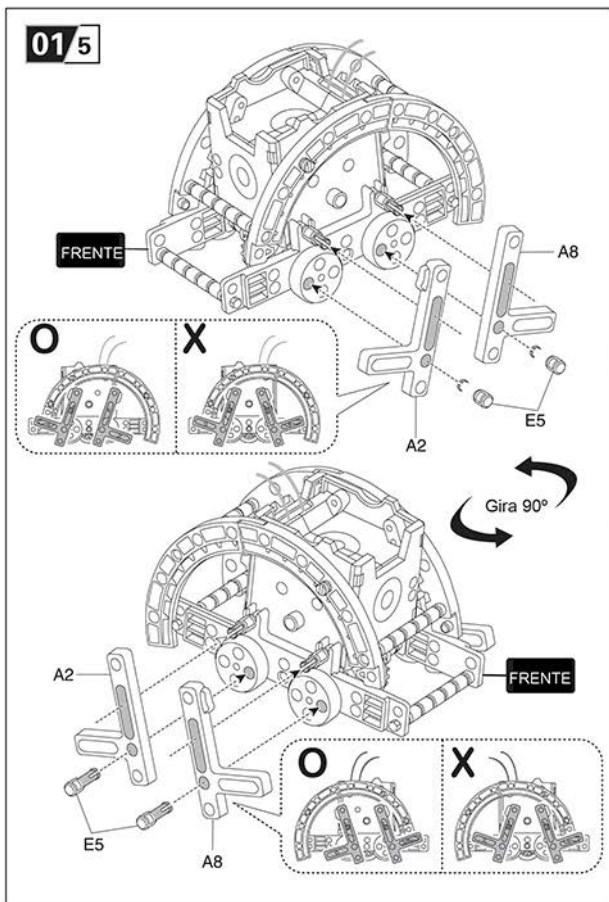

01/6

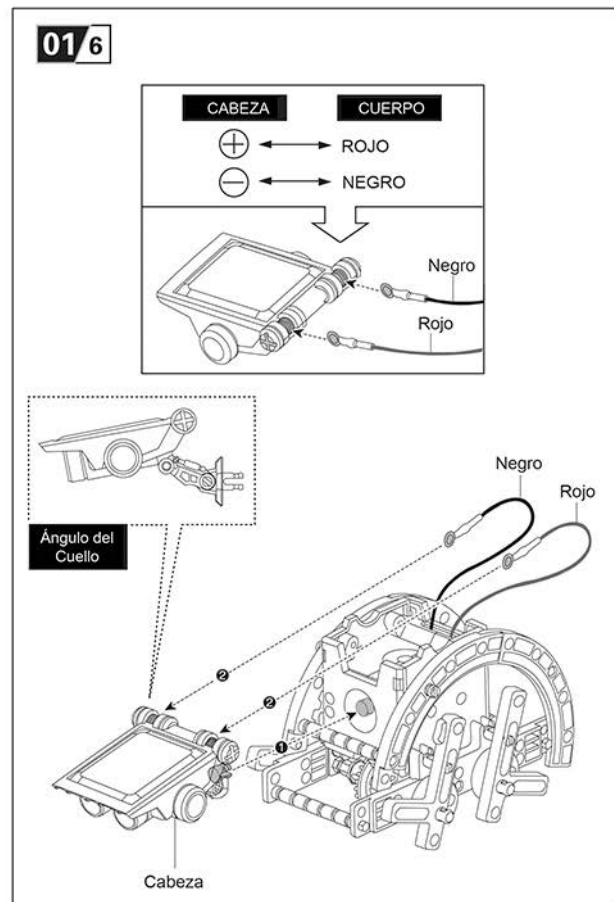

02 Armado el Anda-bot

Nivel 1

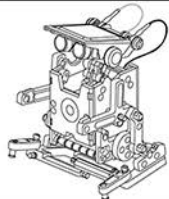

Prepara las piezas de abajo antes de armar el "Anda-bot".



Cuerpo



Cabeza



A1 x1

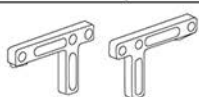

A2 x1

A8 x1



A7 x1



B4 x2



B5 x2



B8 x1



B9 x2



C7 x2



E6 x6



E14 x2



E5 x4



E4 x2



E7 x2



E8 x2



E3 x1

01

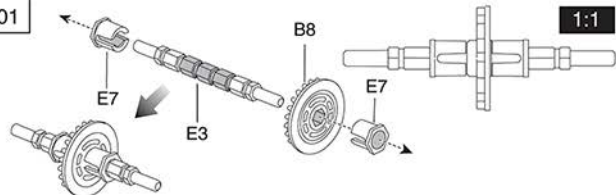

1:1

02



Asegúrate que todos los ejes entre los paneles B4 y B4 están colocadas correctamente y en la posición indicada.

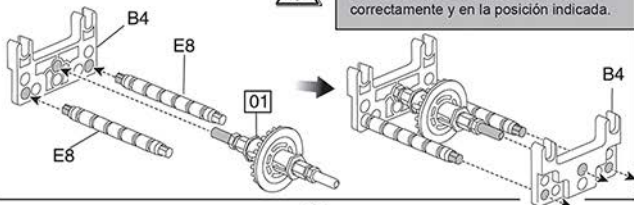

03

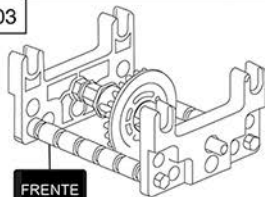

FRETE

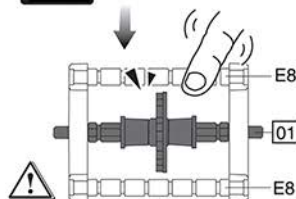

Revisa la Caja de Cambios girándolo con un dedo y asegúrate que gire sin problemas.

02/3

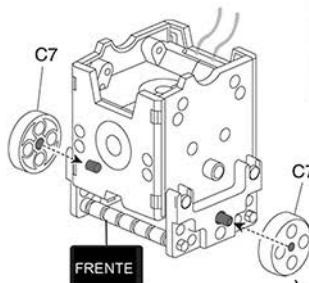

FRETE

02/1

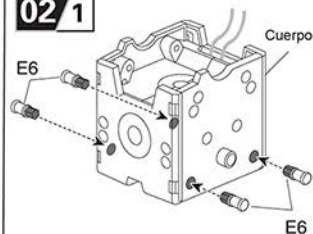

Cuerpo

E6

02/2

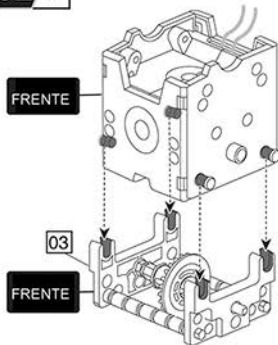

FRETE

FRETE

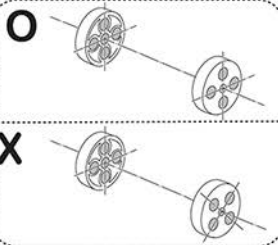

X

02/4

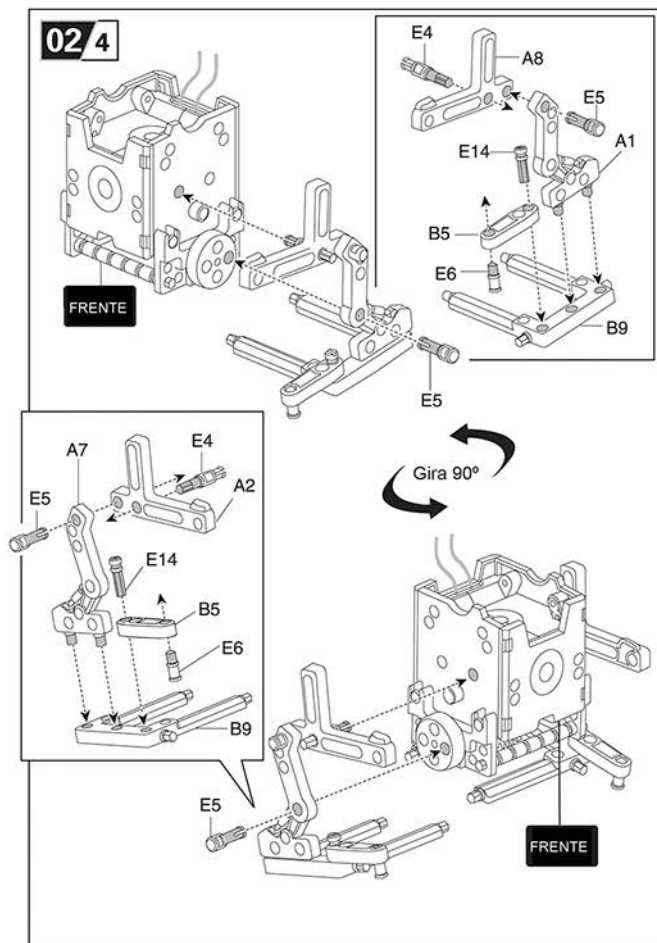

02/5

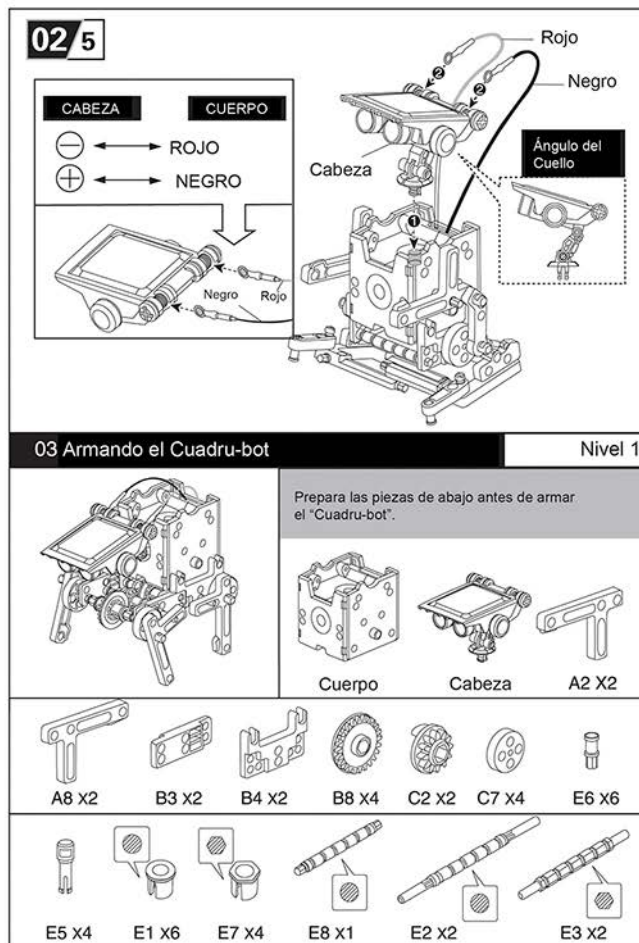

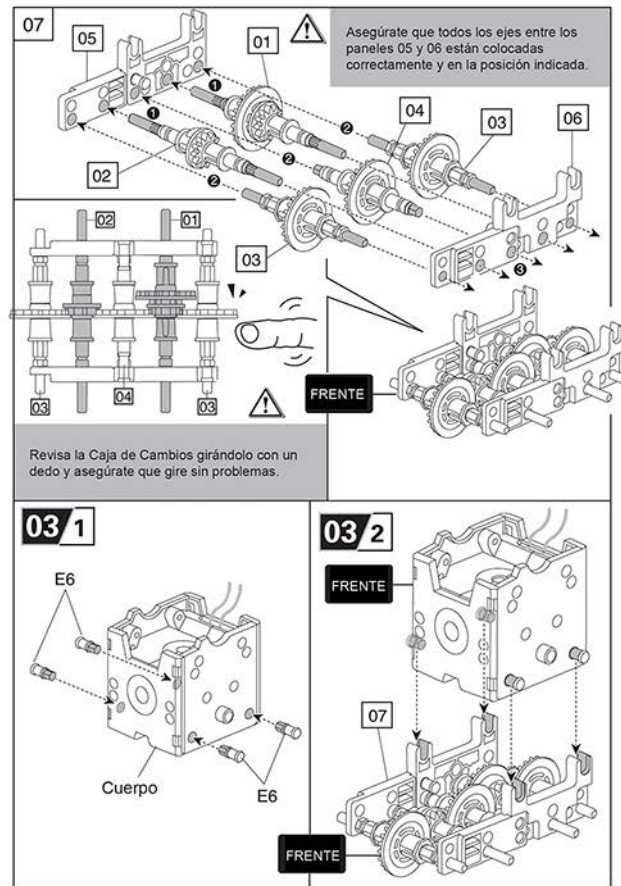
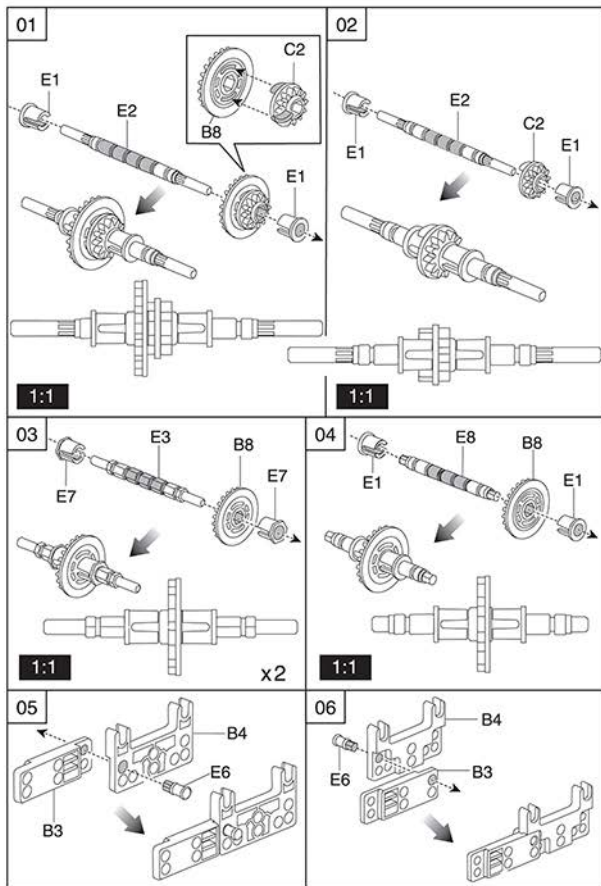

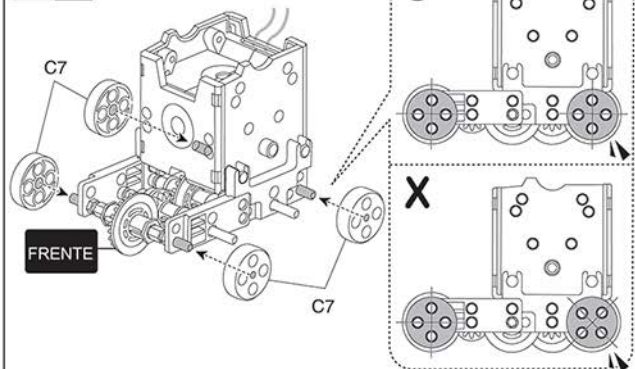
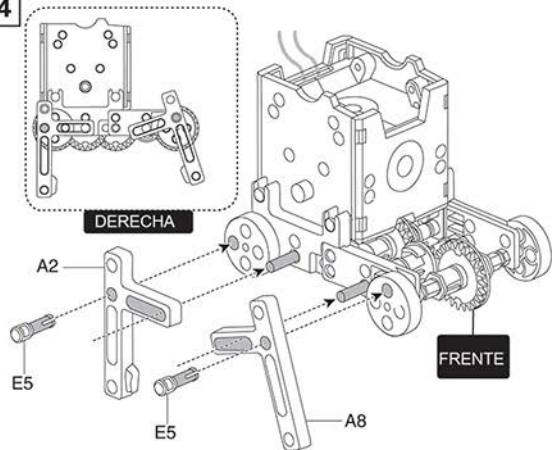
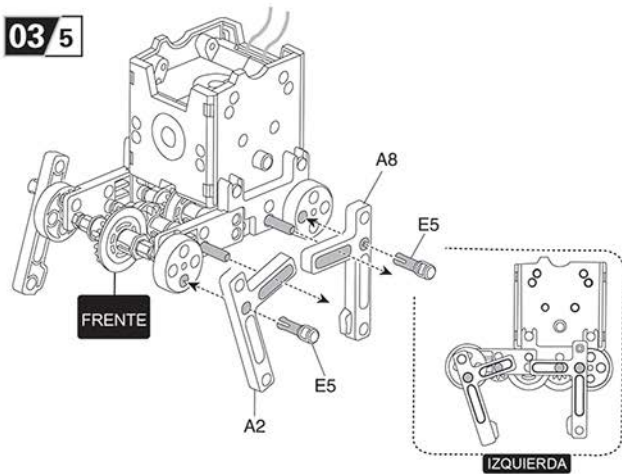
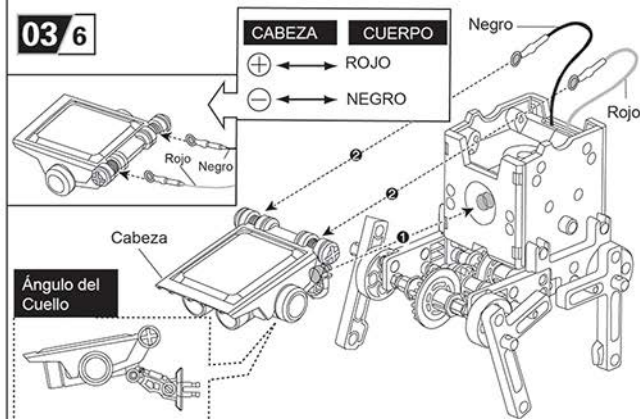
03 3**03 4****03 5****03 6**

04 Armando a Llanta-bot

Nivel 1



Prepara las partes de abajo antes de armar la "Tortuga-bot".



Cuerpo



Cabeza



Llantas x4

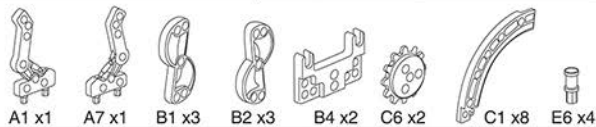

01

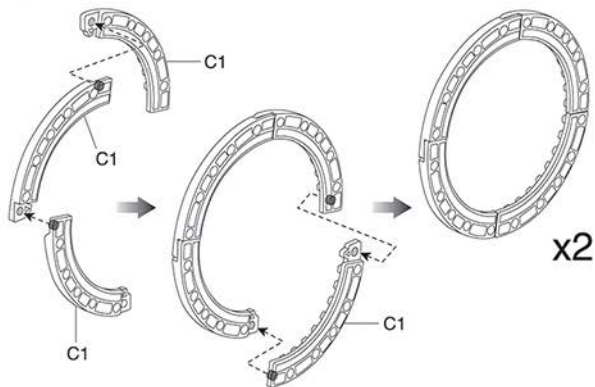

02

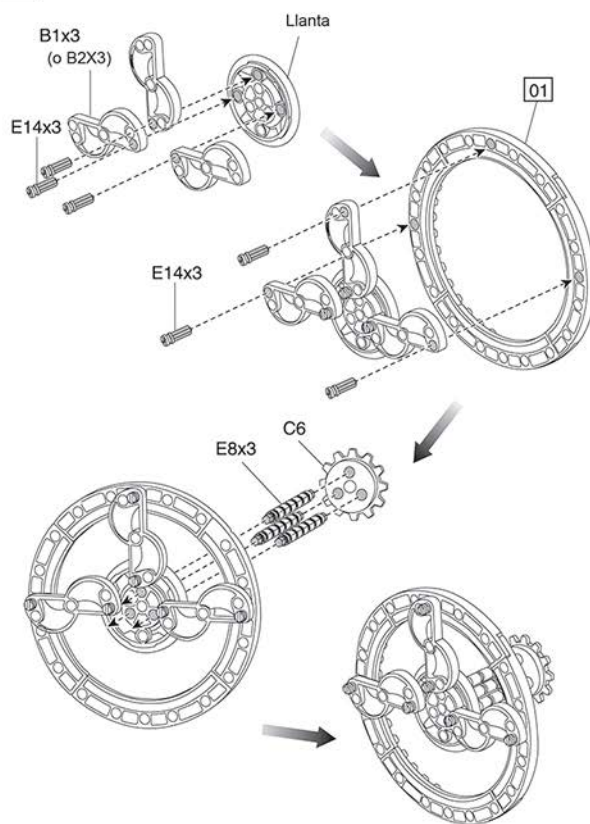

03

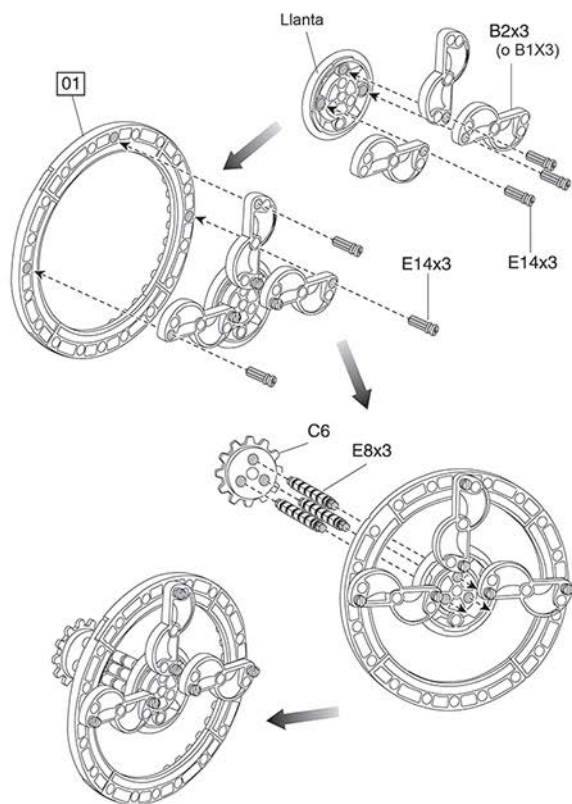

04/1

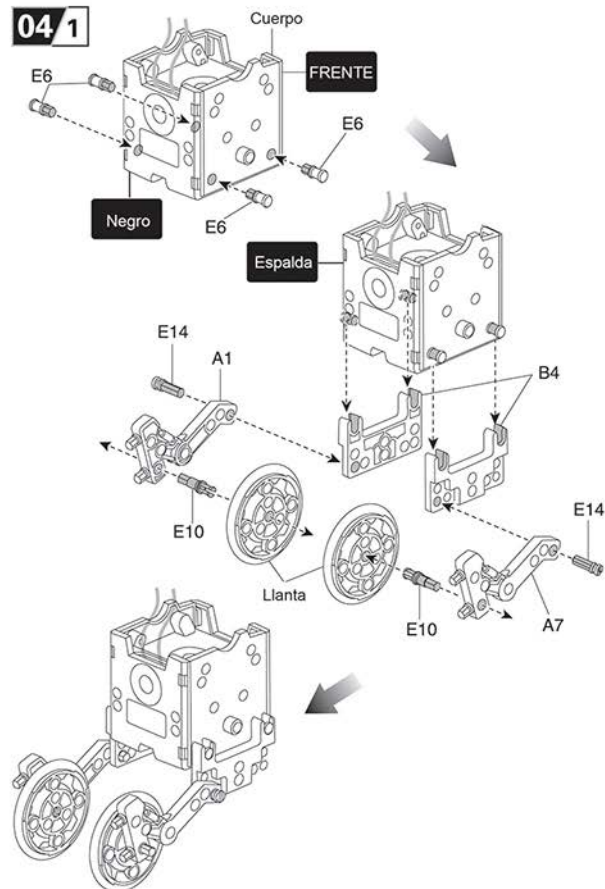

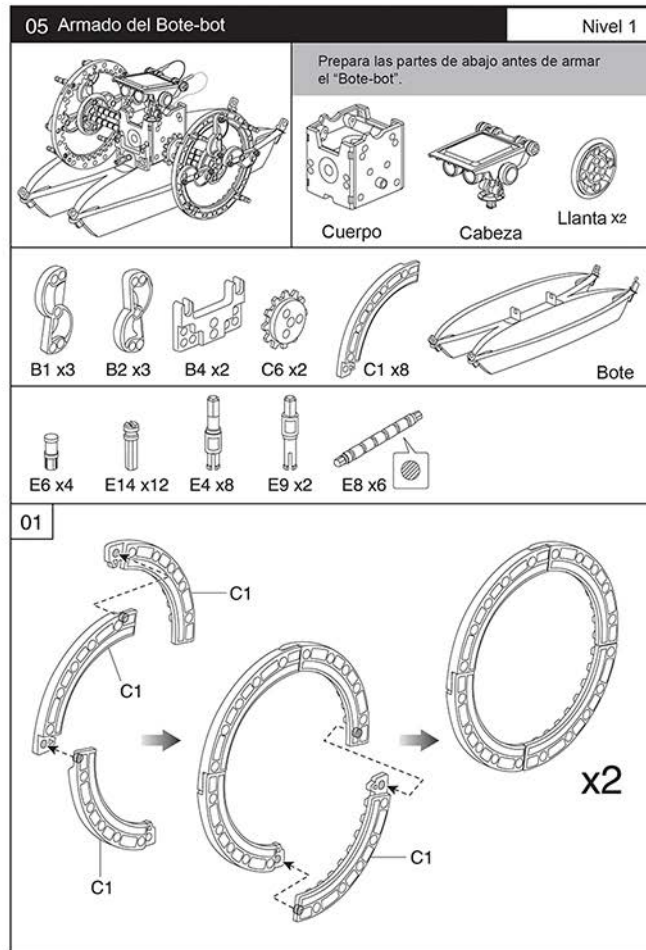
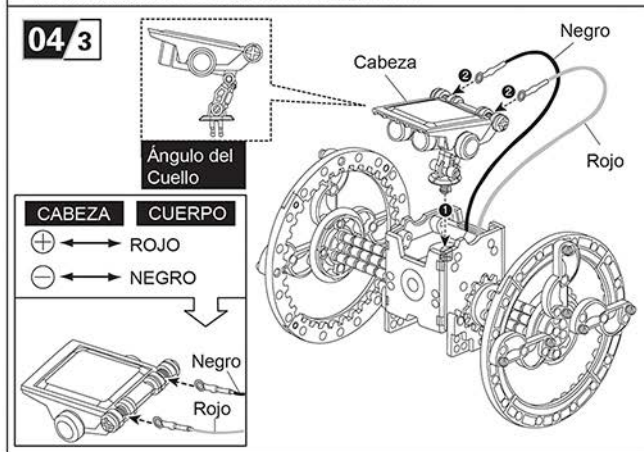
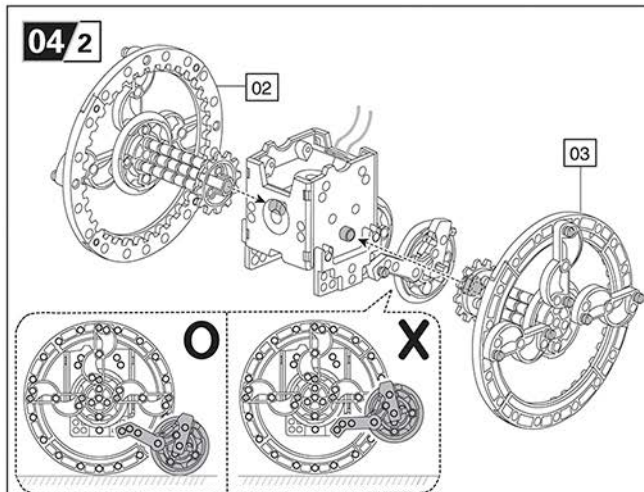

02

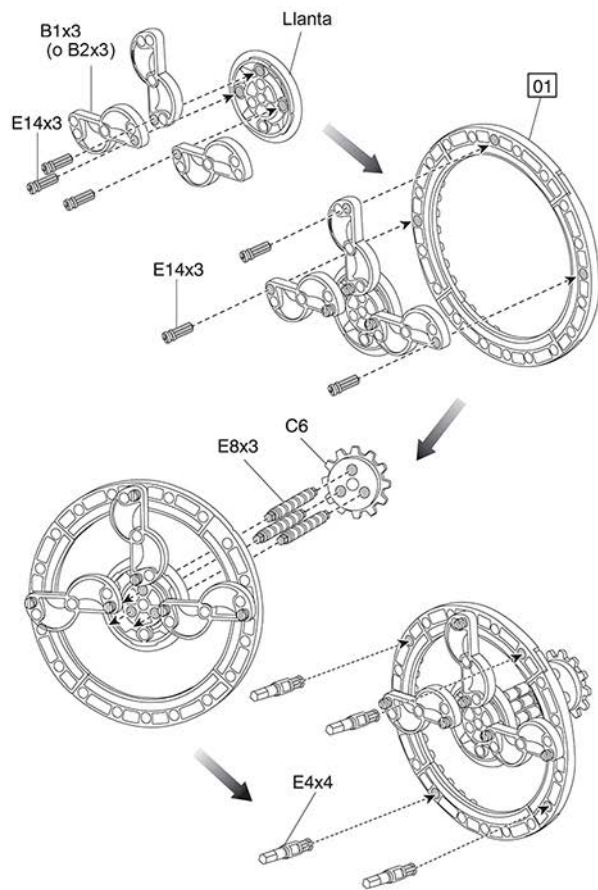

03

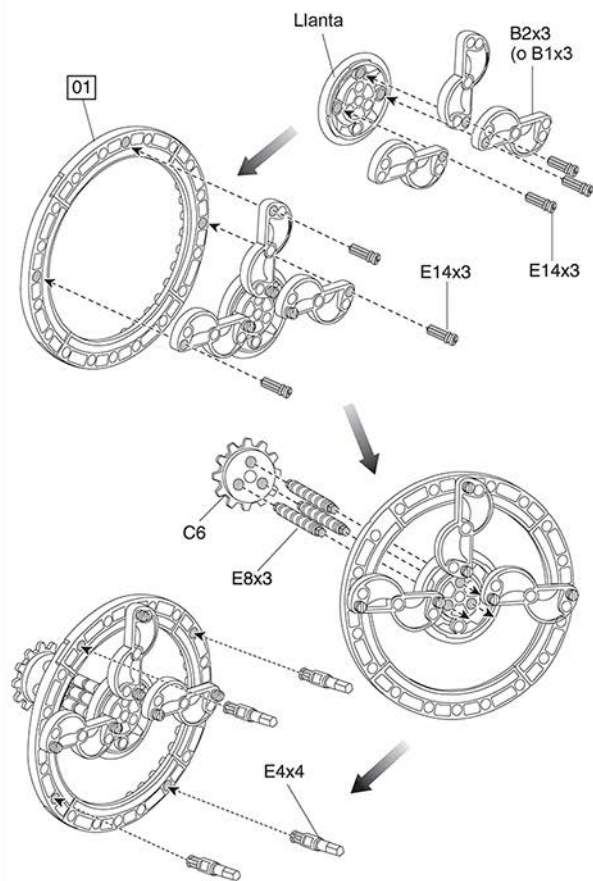

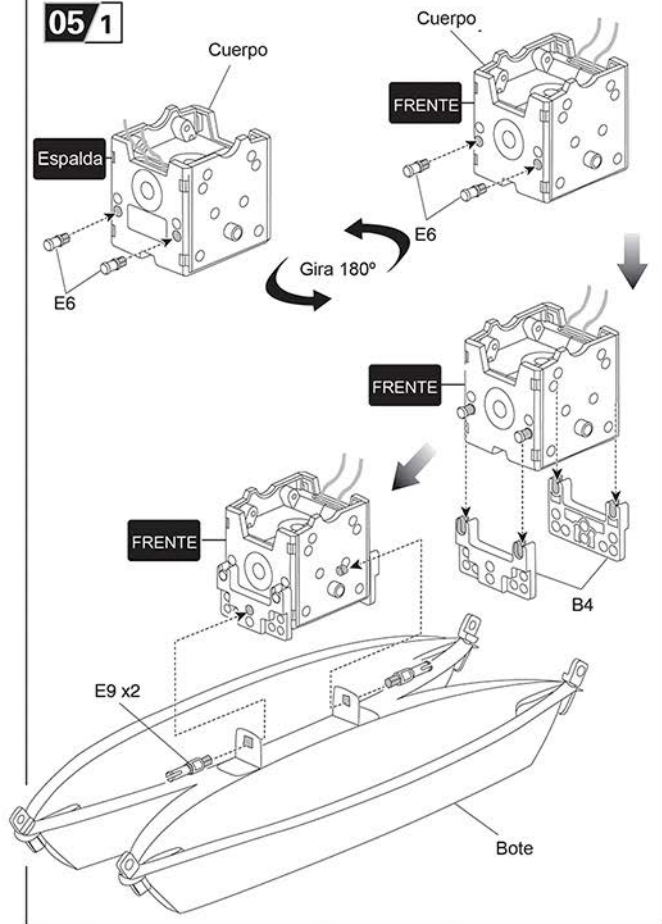
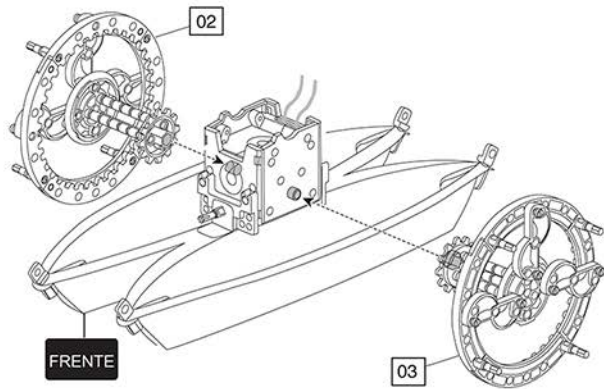
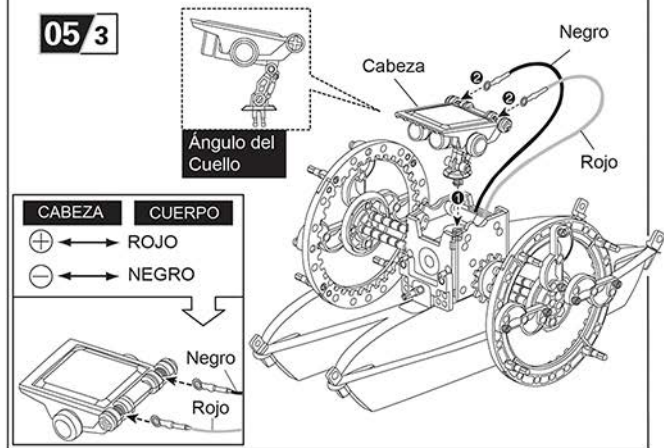
05/1**05/2****05/3**

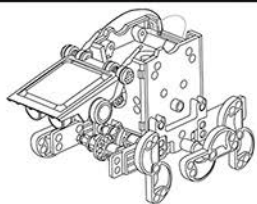

Prepara las partes de abajo antes de armar el "Escara-bot".



Cuerpo



Cabeza



B1 X3

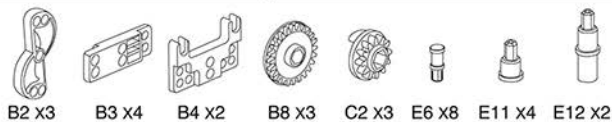

B2 X3

B3 X4

B4 X2

B8 X3

C2 X3

E6 X8

E11 X4

E12 X2

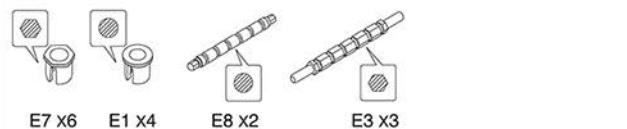

E7 X6

E1 X4

E8 X2

E3 X3

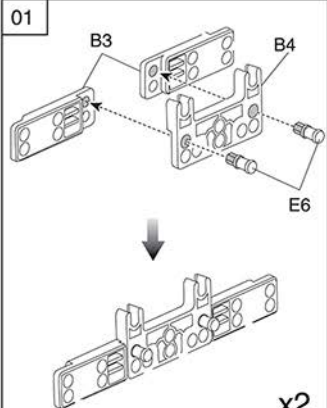

01

B3

B4

E6

x2

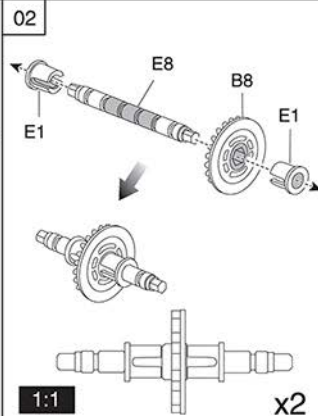

02

E8

B8

E1

1:1

x2

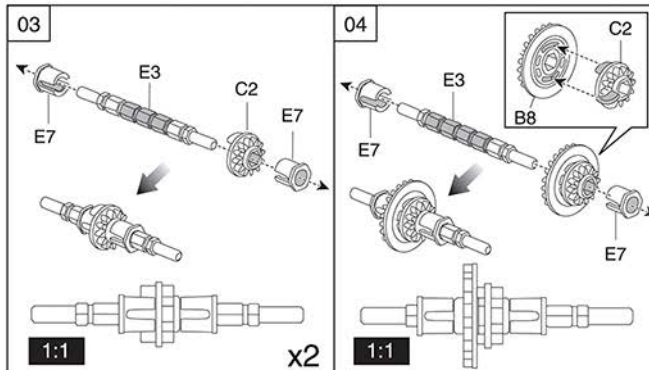

03

E3

E7

E7

1:1

x2

04

E3

E7

E7

1:1

C2

B8

E7

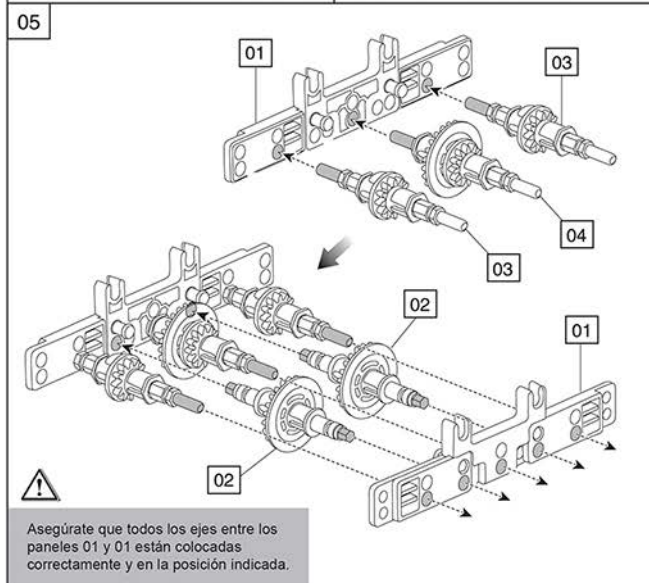

05

01

03

04

03

02

01

02



Asegúrate que todos los ejes entre los paneles 01 y 01 están colocados correctamente y en la posición indicada.

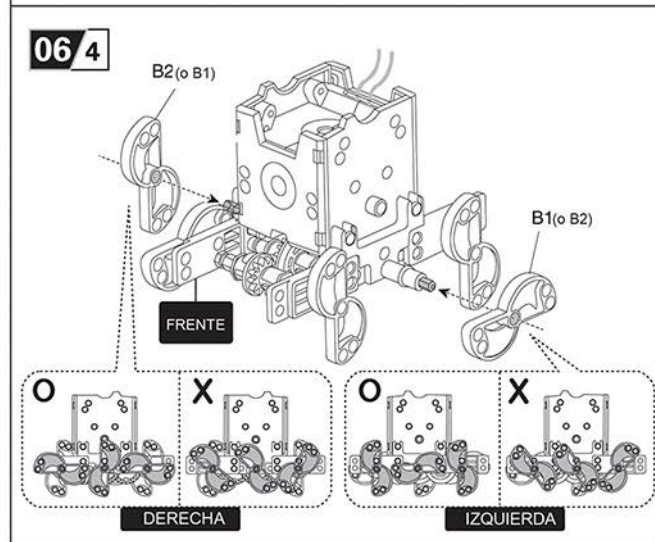
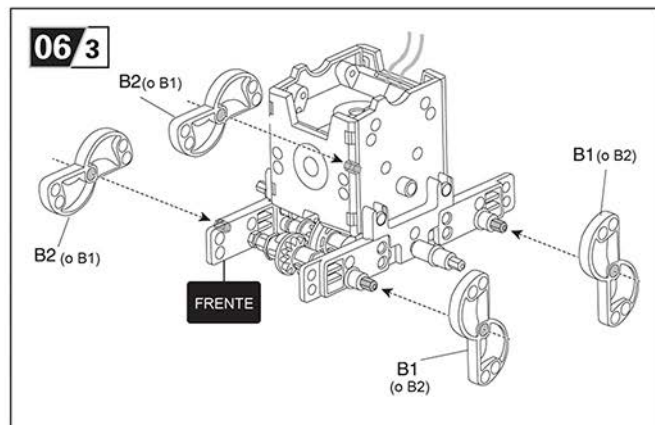
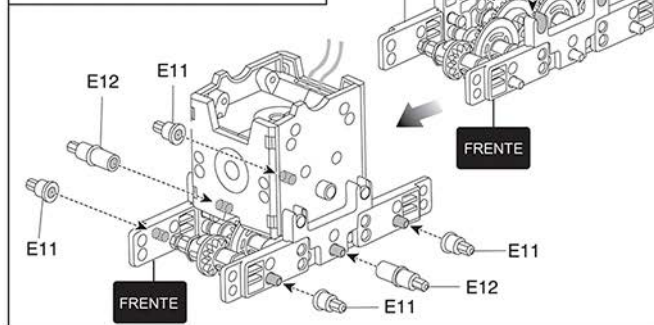
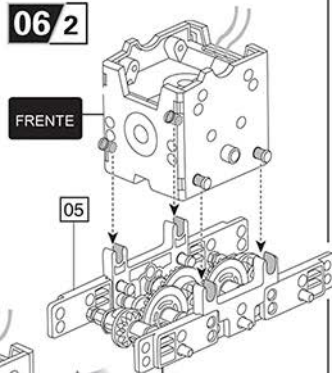
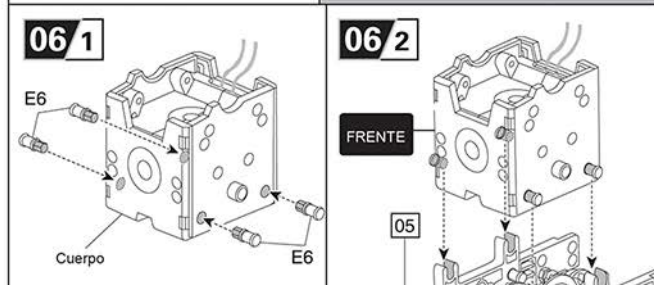
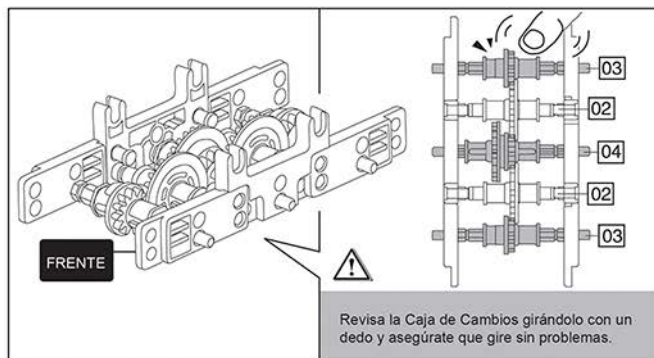

06 / 5

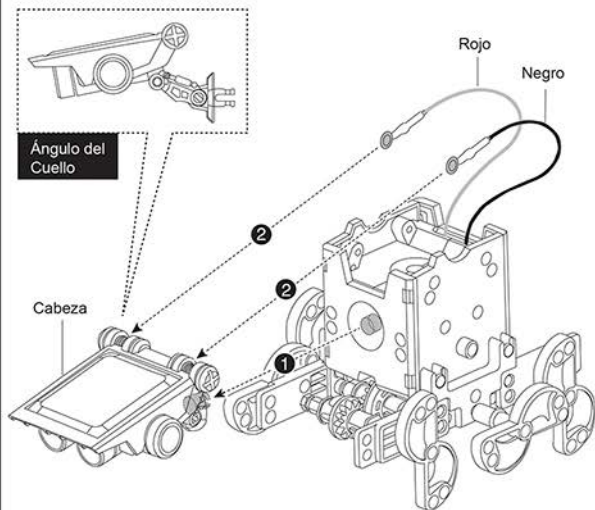
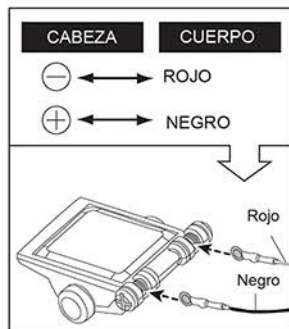

07 Armado del Perro-bot

Nivel 1

Prepara las partes de abajo antes de armar la 'Perro-bot'.



Cuerpo

Cabeza

A2 X1



A8 X1

B1 X1

B2 X1

B3 X2

B4 X2

B5 X2

B7 X1

B8 X2

C2 X3



E6 X5

E14 X3

E10 X2

E11 X2

E7 X4

E1 X4

E8 X3

E3 X2

01

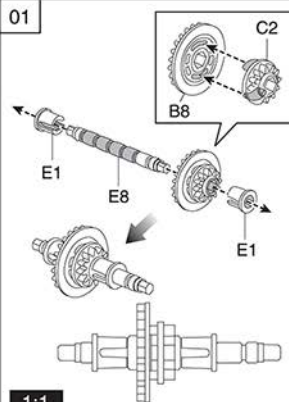

1:1

02

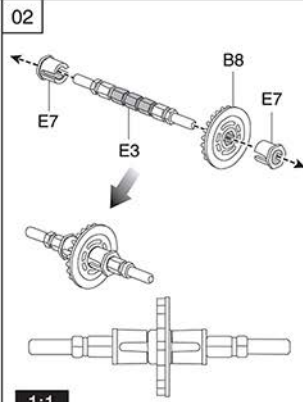

1:1

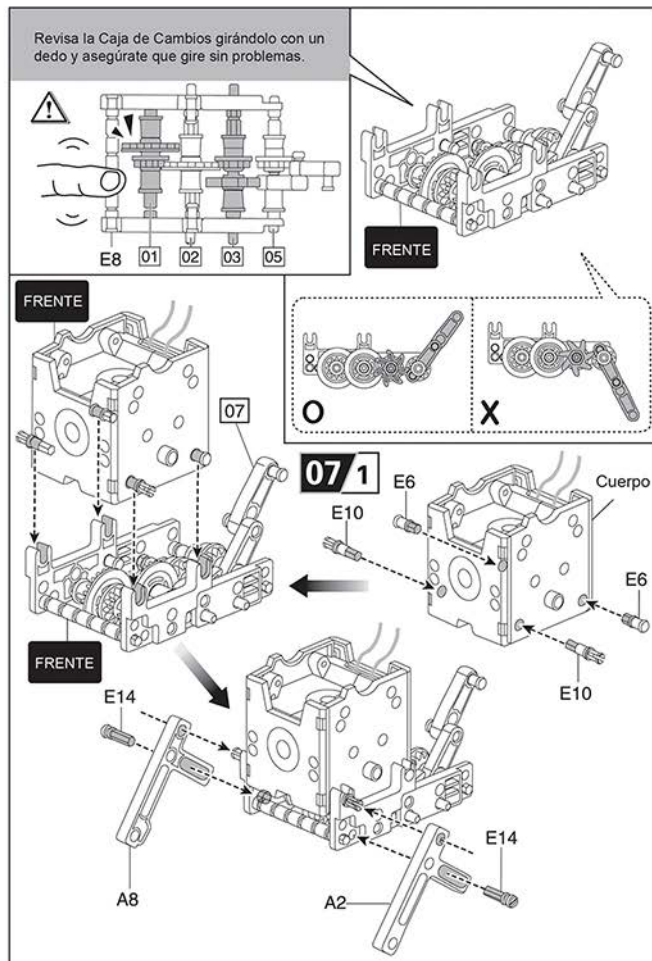
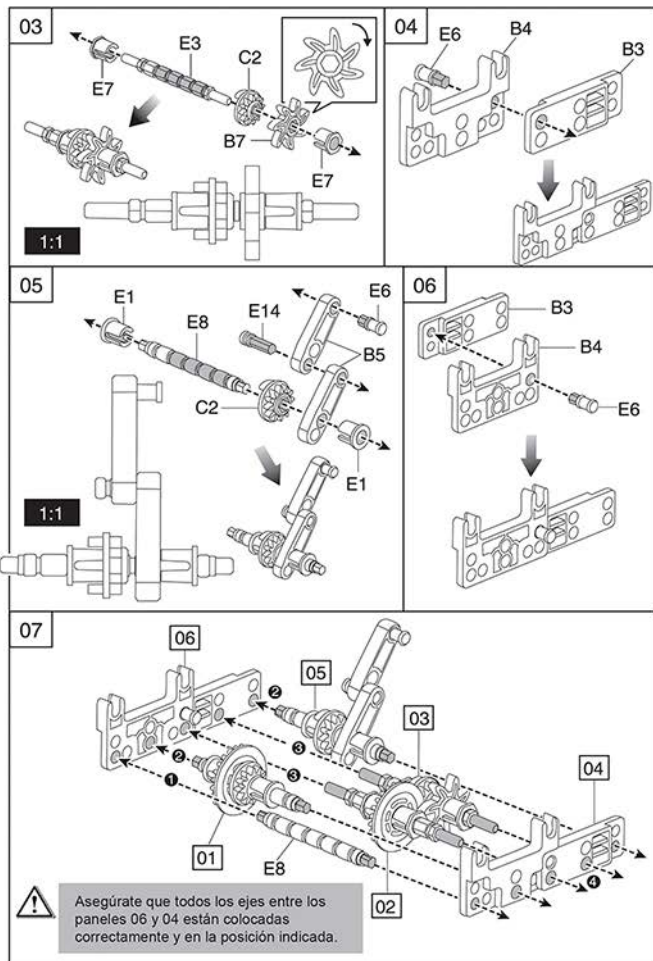

07/2

B2 (o B1)

E11

Movimiento 1:
¡Temblando y
moviendo la cola!

Movimiento 2:
¡Saltando y
moviendo la cola!

E11

B1
(o B2)**07/3**

Cabeza

Negro

Rojo

CABEZA	CUERPO
⊕	↔ ROJO
⊖	↔ NEGRO

Ángulo del
Cuello

Negro

Rojo

08 Armado del Auto-bot**NIVEL 2**

Prepara las partes de abajo antes de armar
el "Auto-bot".



Cuerpo



Cabeza



Llantas x4



B3 x4



B4 x2



B8 x4



C1 x2



C2 x4



E6 x8



E14 x2



E4 x4



E11 x4



E7 x2



E1 x10



E8 x7

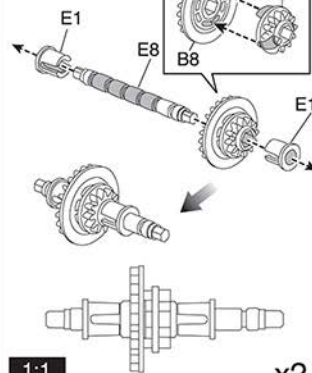
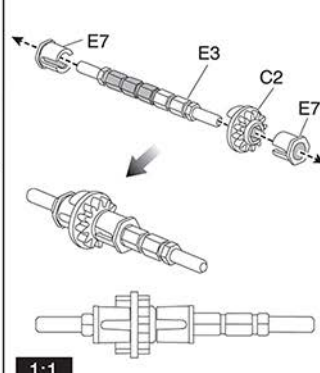

E3 x2

01**1:1****x2****02****1:1**

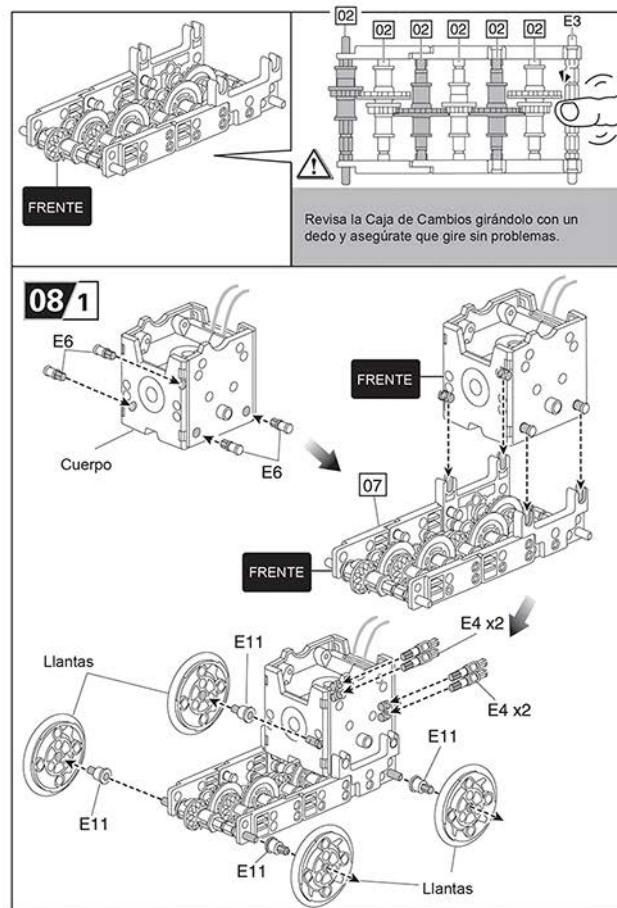
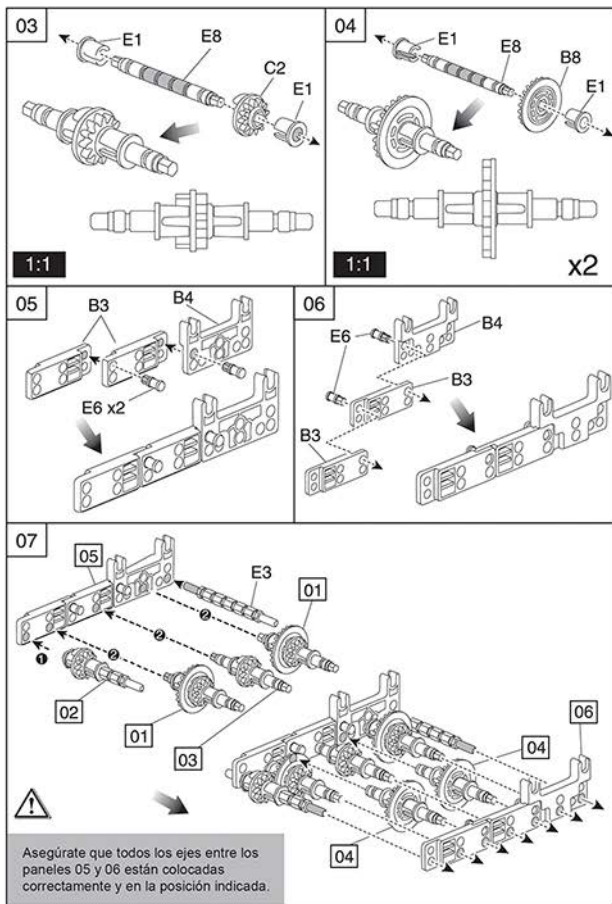

08/2

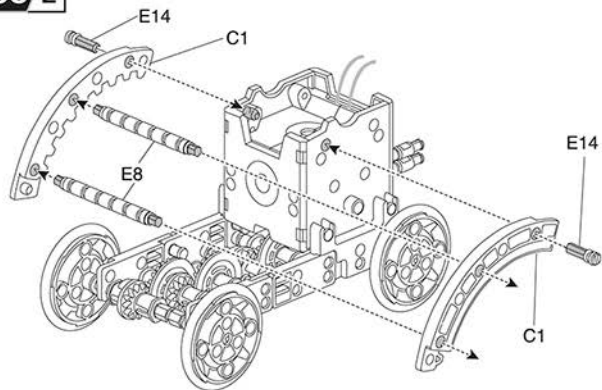

08/3

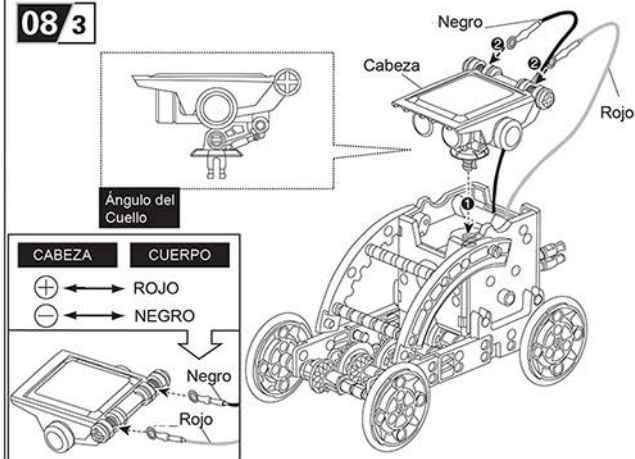

09 Armado del "Cangre-bot"

Nivel 2



Prepara las partes de abajo antes de armar el "Cangre-bot".

Cuerpo

Cabeza

A2 X2

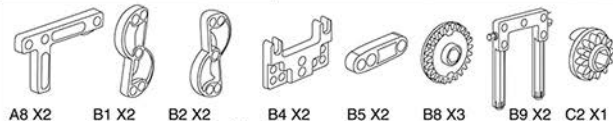

A8 X2

B1 X2

B2 X2

B4 X2

B5 X2

B8 X3

B9 X2

C2 X1



C7 X4

E14 X4

E5 X8

E4 X10

E7 X4

E1 X2

E8 X1

E3 X2

01

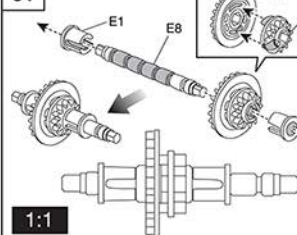

1:1

02

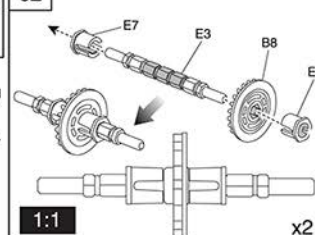

1:1

x2

03

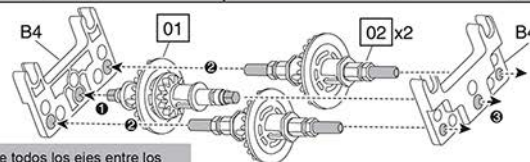

Asegúrate que todos los ejes entre los paneles 03 y 03 están colocadas correctamente y en la posición indicada.

04

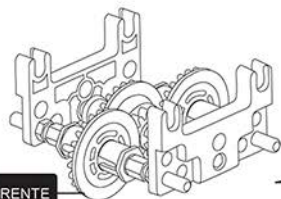

FRENTE

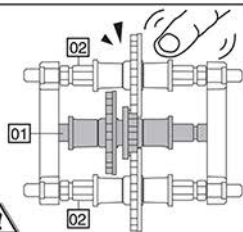

Revisa la Caja de Cambios girándola con un dedo y asegúrate que gire sin problemas.

09 1

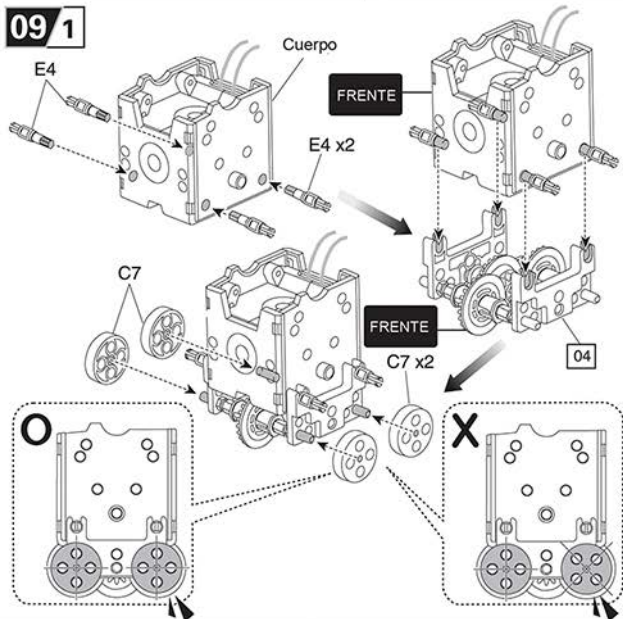

09 2

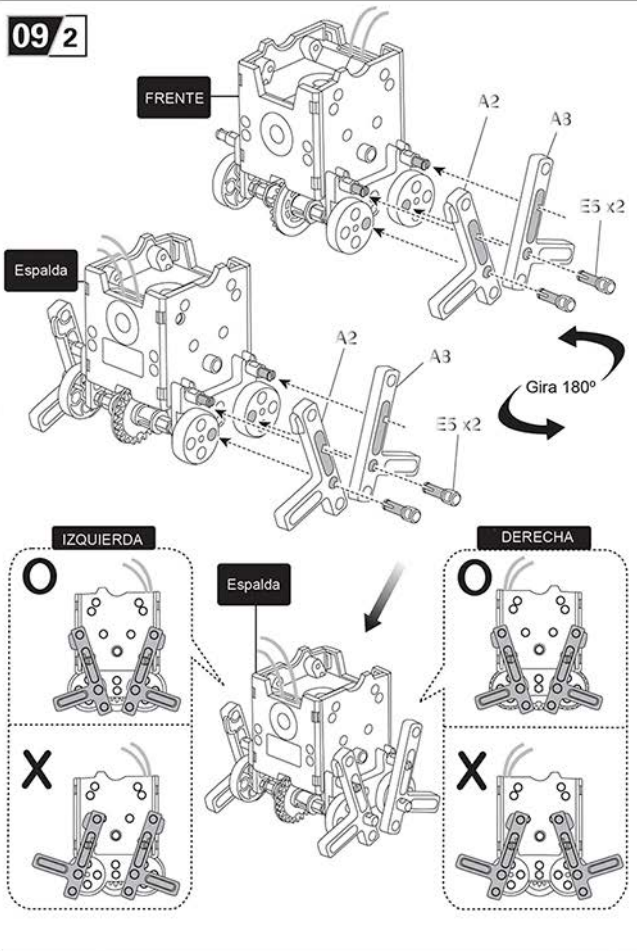

09/3

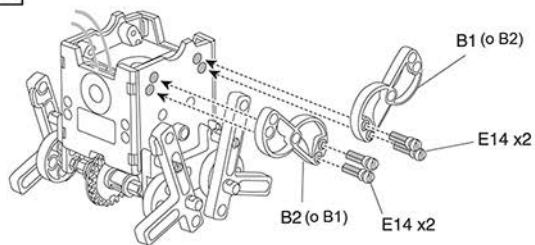

09/4

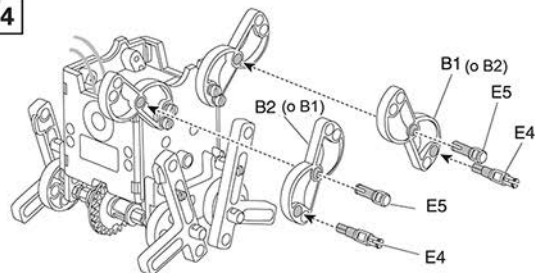

09/5

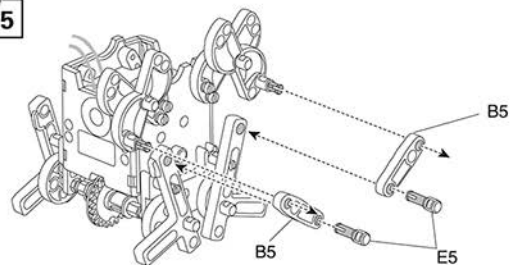

09/6

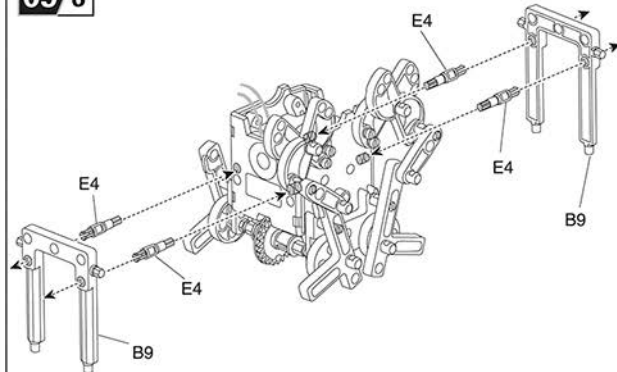

09/7

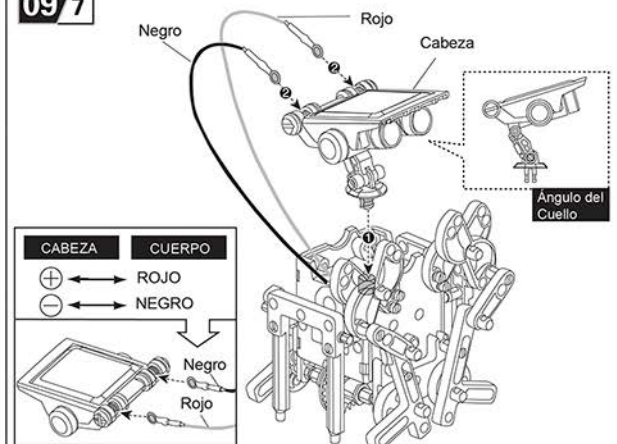

10 Armando el Desliza-bot

Nivel 2

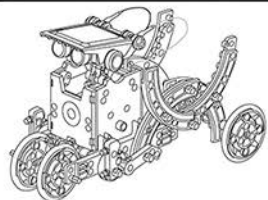

Prepara las partes de abajo antes de armar el "Desliza-bot".

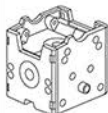

Cuerpo



Cabeza



Llantas x4

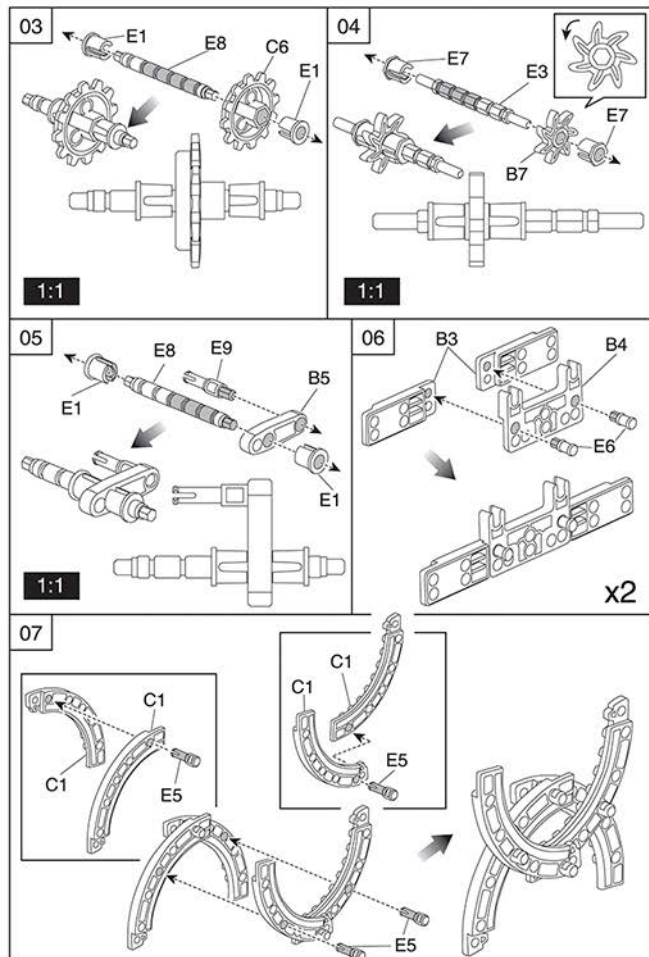
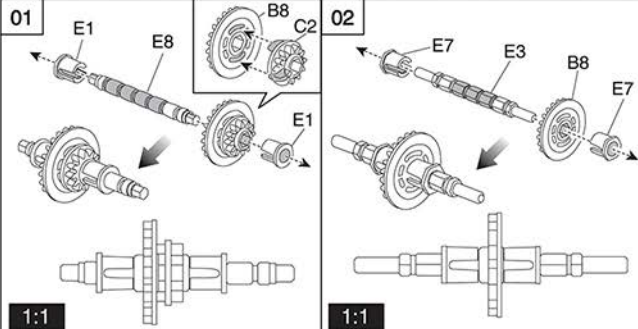
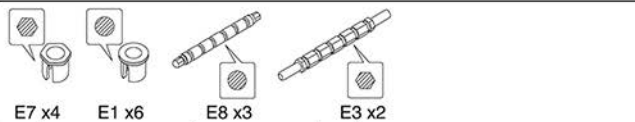
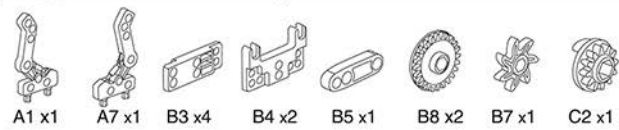

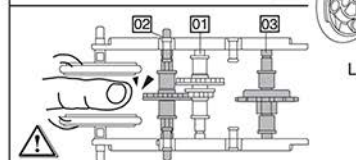
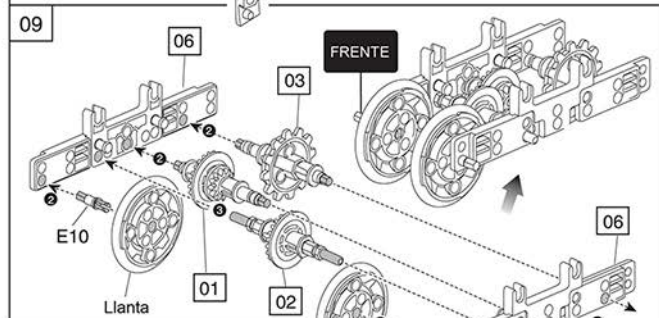
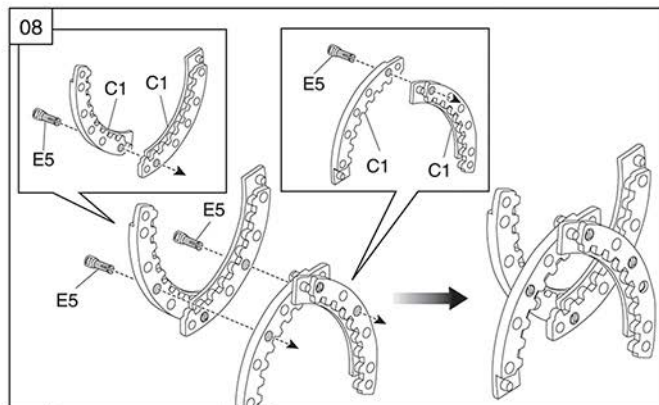

Revisa la Caja de Cambios girándolo con un dedo y asegúrate que gire sin problemas.

Asegúrate que todos los ejes entre los paneles 06 y 06 están colocadas correctamente y en la posición indicada.

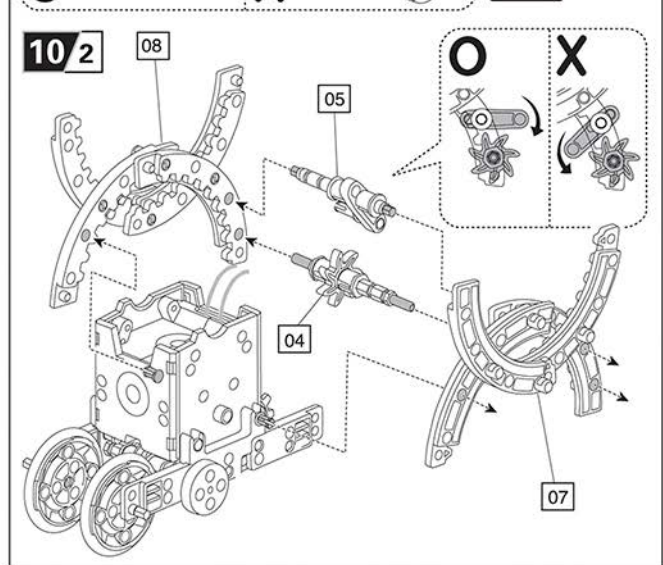
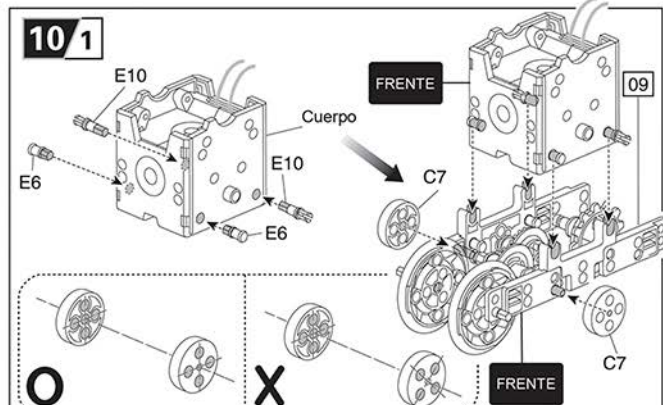

10/3

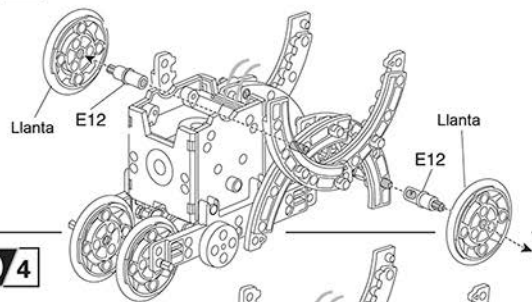

10/4

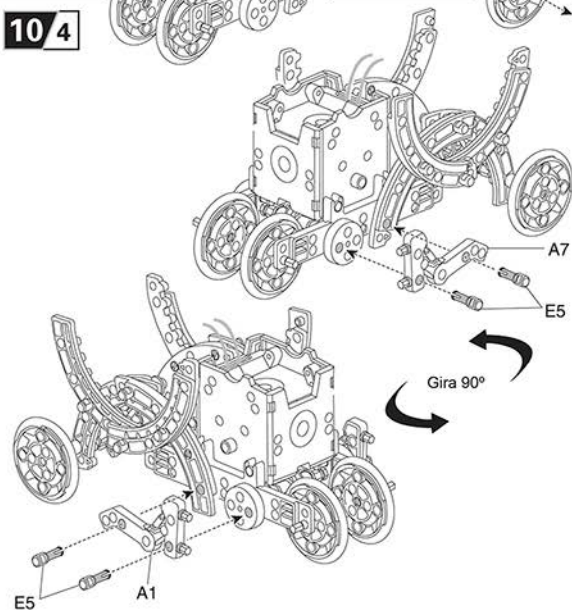

10/5

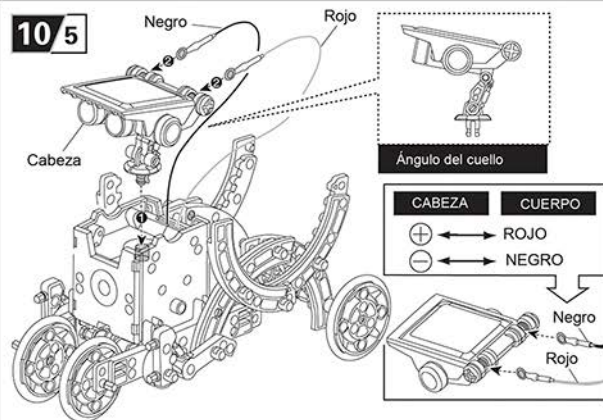

11 Armando el Rodi-bot

Nivel 2



Prepara las partes de abajo antes de armar el "Rodi-bot".



Cuerpo



Cabeza



Llantas x2



A2 x2



A8 x2



B1 x2



B2 x2



B8 x4



C1 x8



C6 x2



E14 x10



E4 x8

01

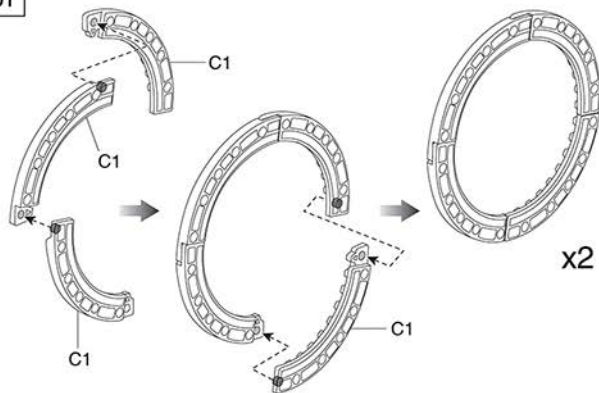

11/1

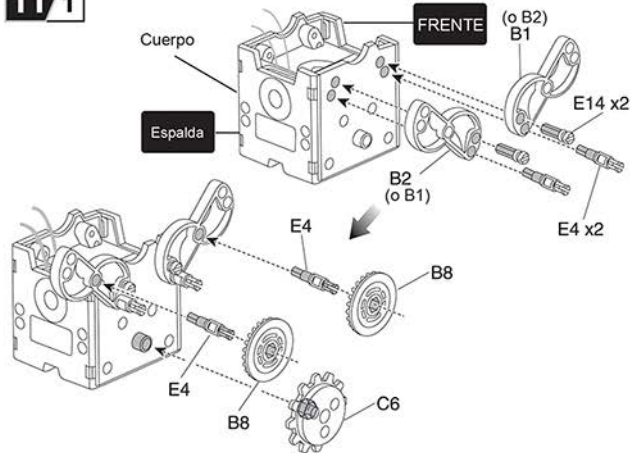

11/2

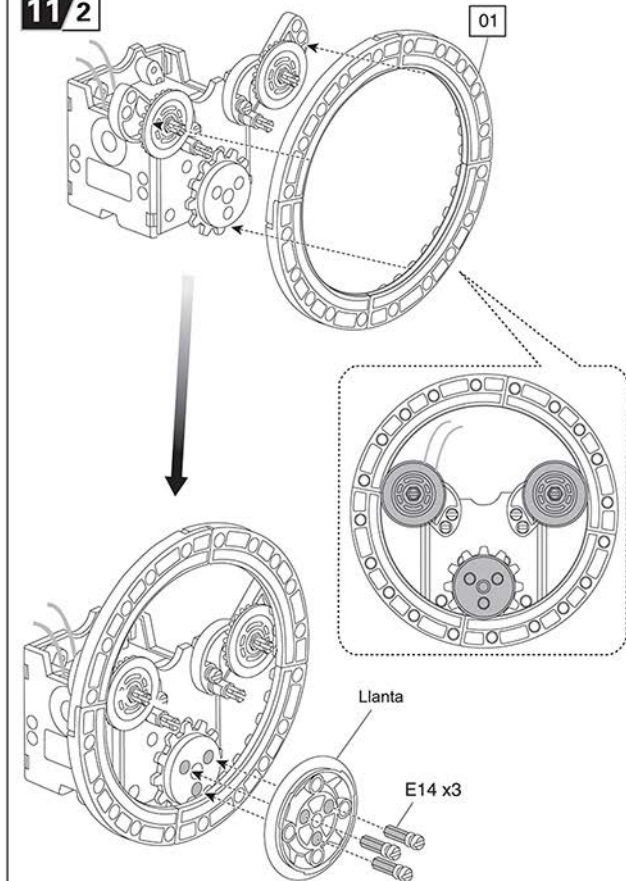

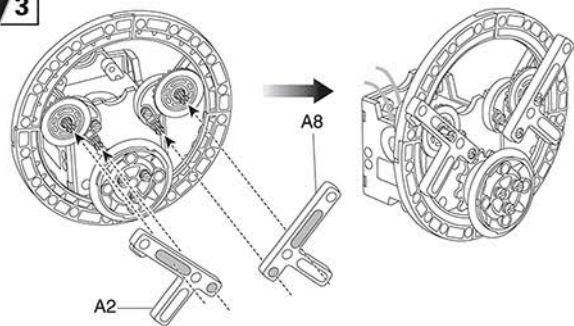
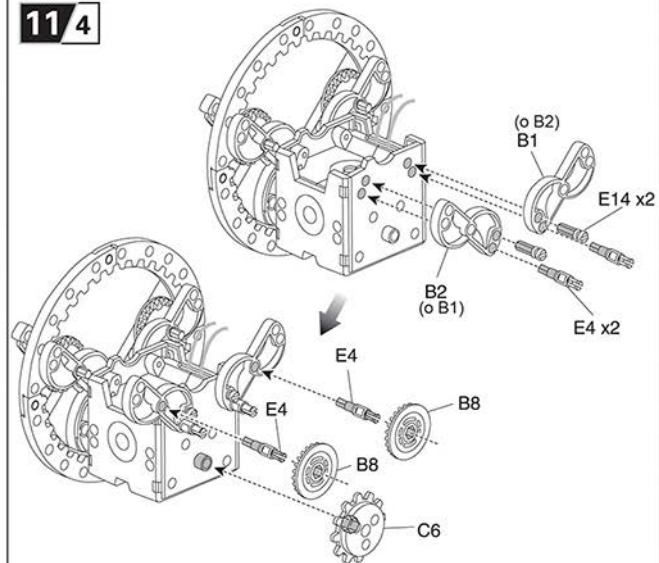
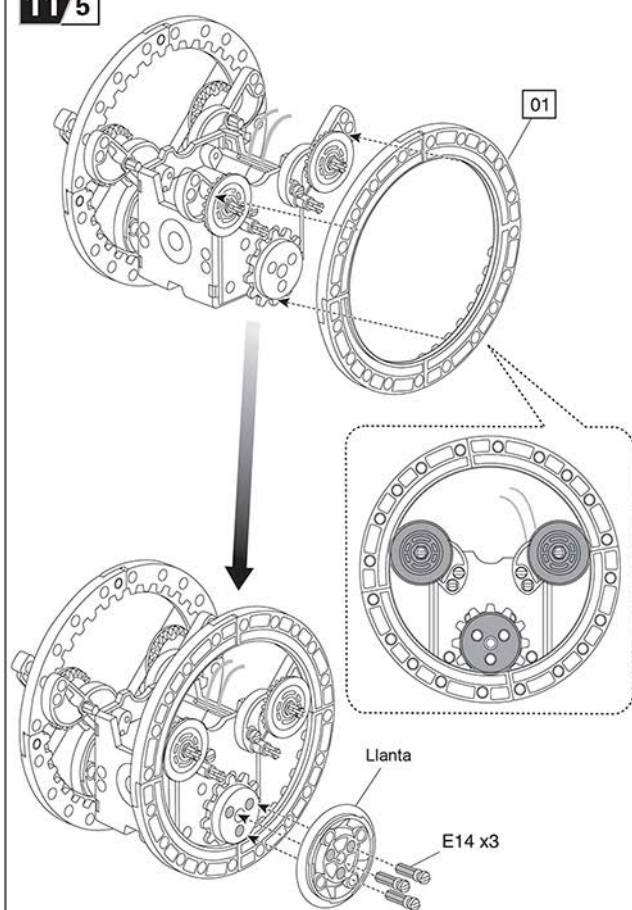
11/3**11/4****11/5**

11/6

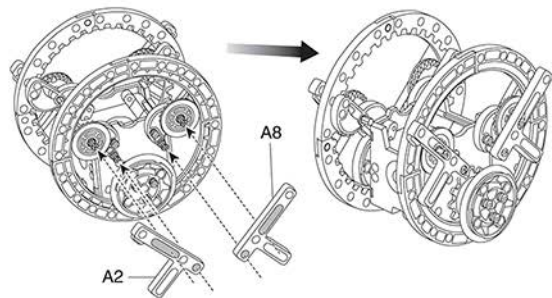

11/7

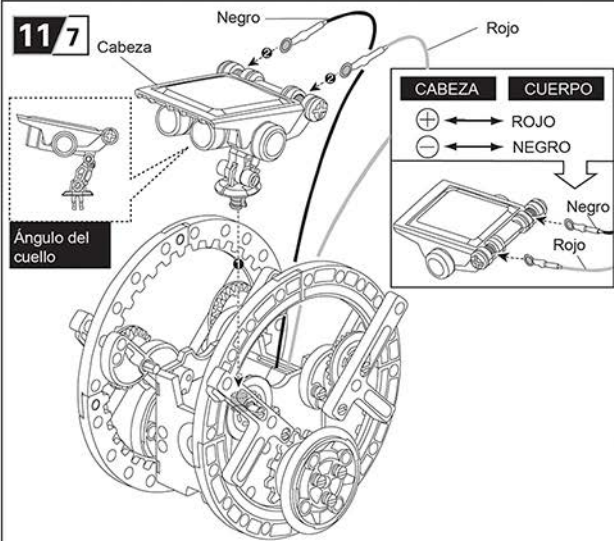

12 Armado del "Zombie-bot"

Nivel 2

Prepara las partes de abajo antes de armar el "Zombie-bot".

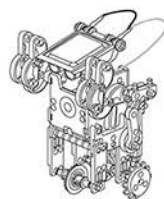

Cuerpo



Cabeza



A1 x1

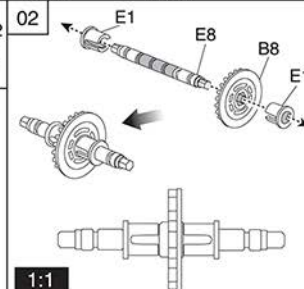
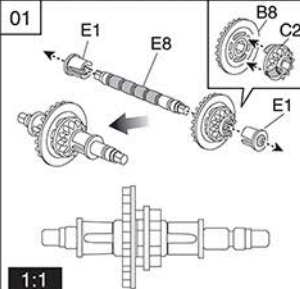
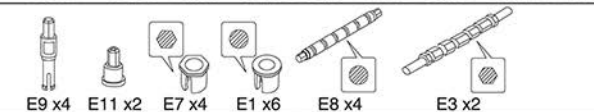
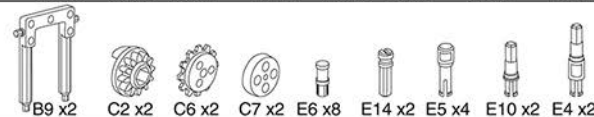
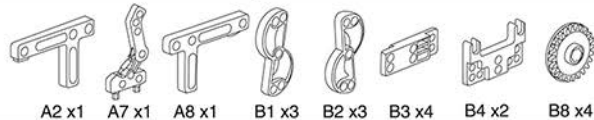

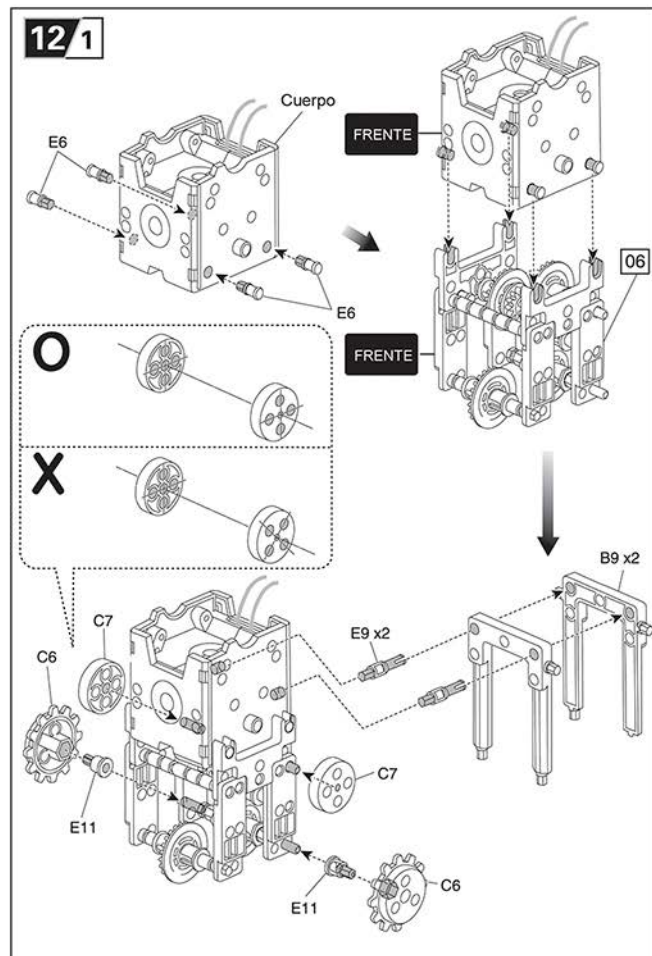
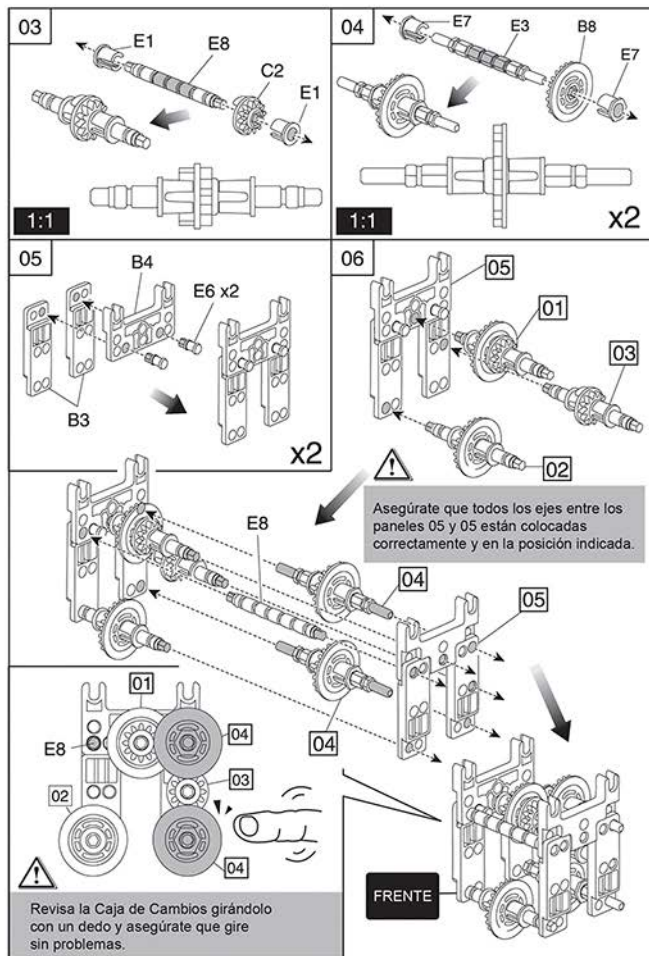

12/2

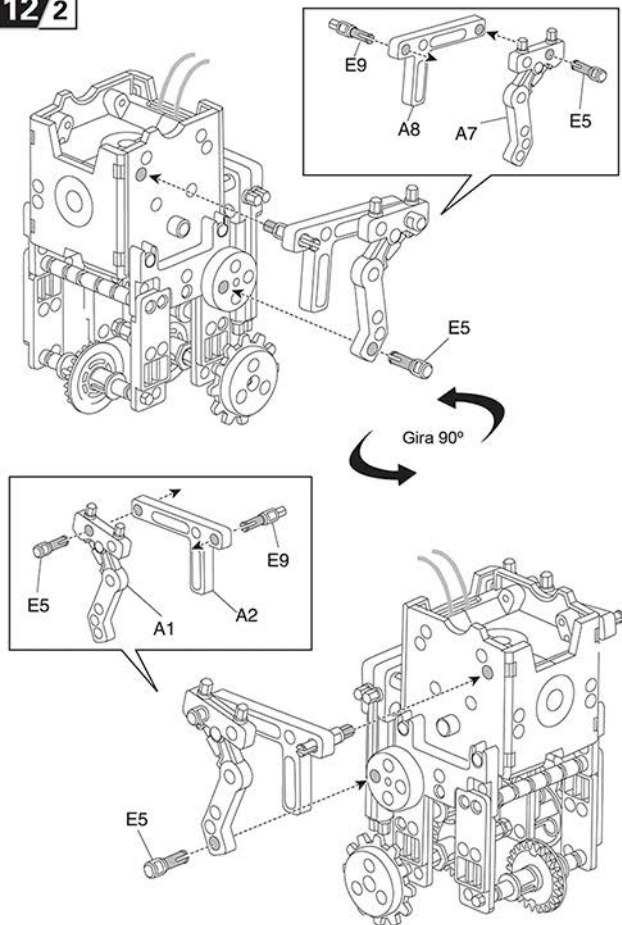

12/3

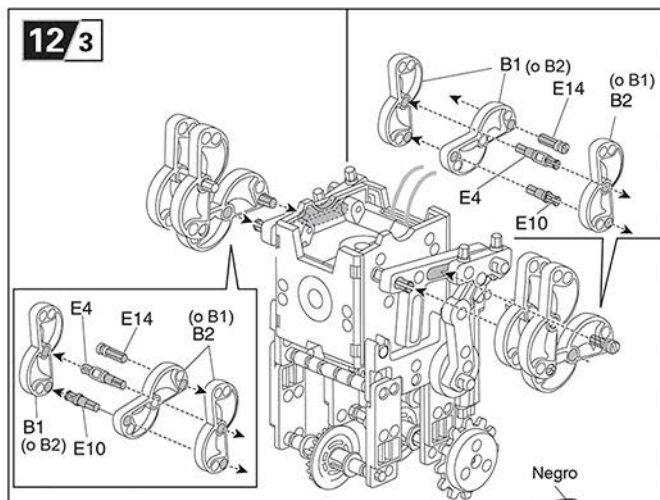

12/4

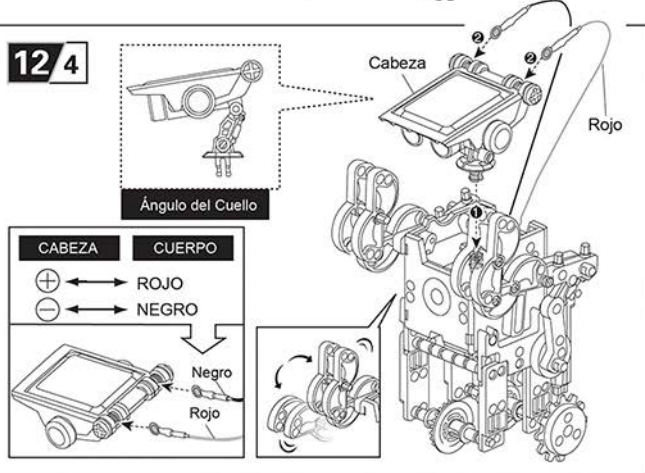

13 Armado del "Surfer-bot"

Nivel 2

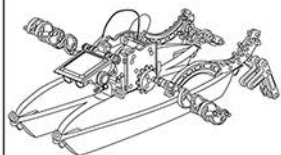

Prepara las partes de abajo antes de armar el "Surfer-bot".



Cuerpo



Cabeza



A1 X1

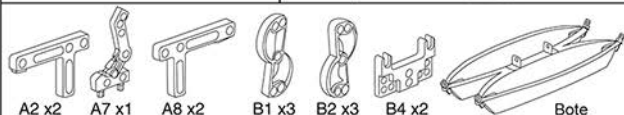

A2 x2

A7 x1

A8 x2

B1 x3

B2 x3

B4 x2

Bote

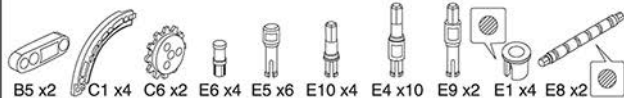

B5 x2

C1 x4

C6 x2

E6 x4

E5 x6

E10 x4

E4 x10

E9 x2

E1 x4

E8 x2

01

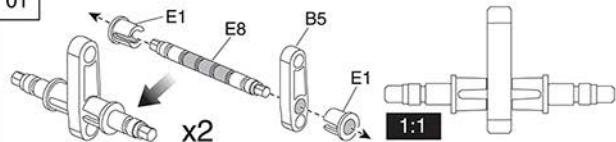

x2

1:1

13/1

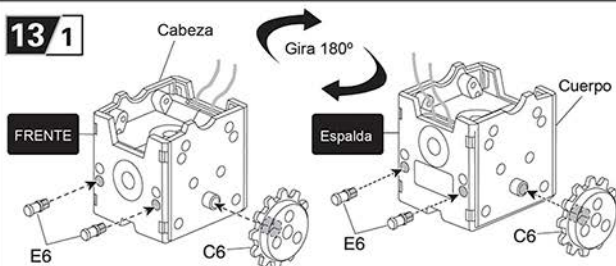

Cabeza

Gira 180°

Cuerpo

FRENTE

Espalda

E6

C6

E6

C6

13/2

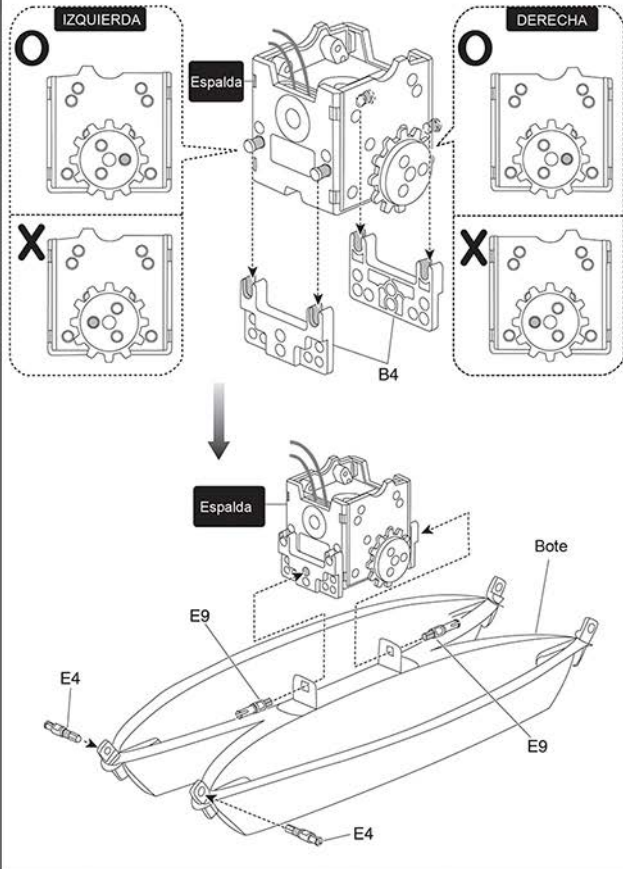

IZQUIERDA

DERECHA

Espalda

Espalda

Bote

E9

E9

E4

E4

E4

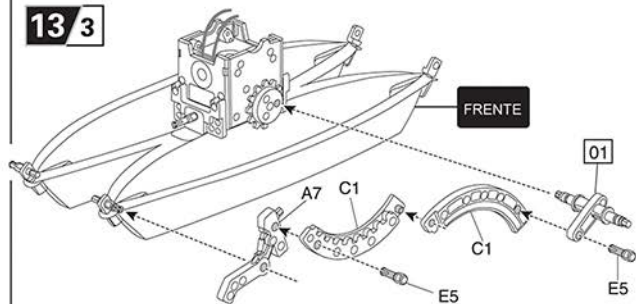
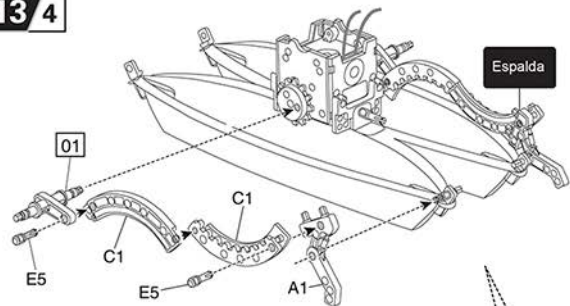
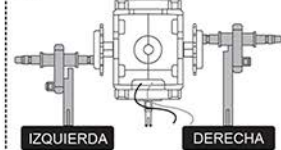
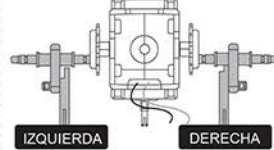
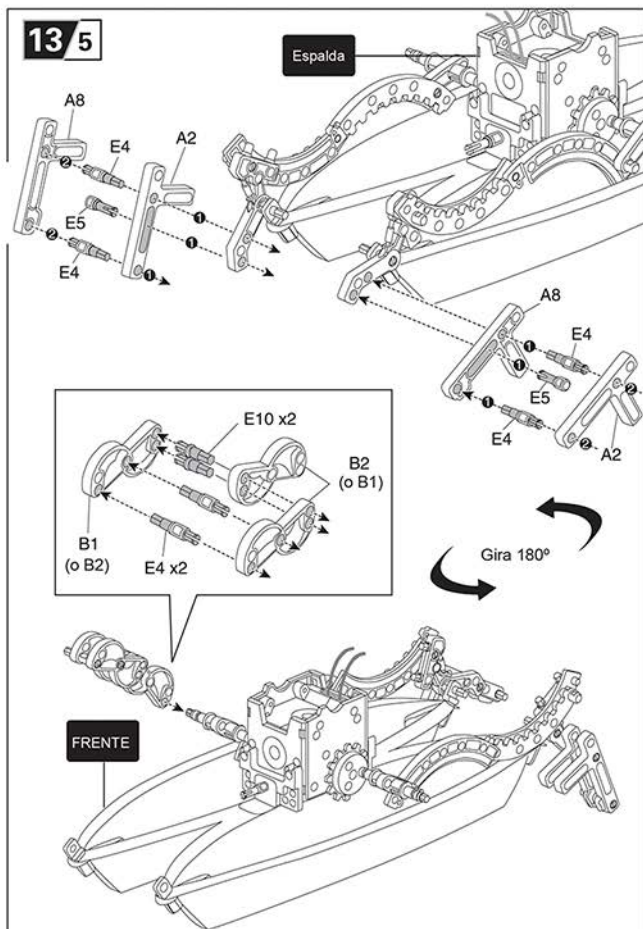
13/3**13/4****O****X****13/5**

Espalda

A8

E4

A2

E5

E4

A8

E4

E5

E4

A2

E10 x2

B2

(o B1)

B1

(o B2)

E4 x2

Gira 180°

FRENTE

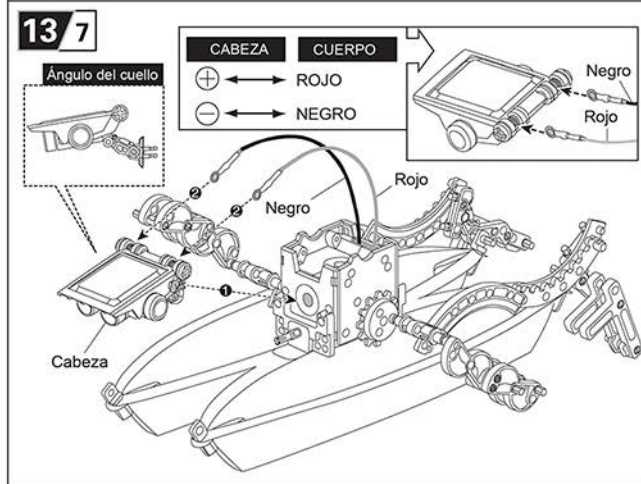
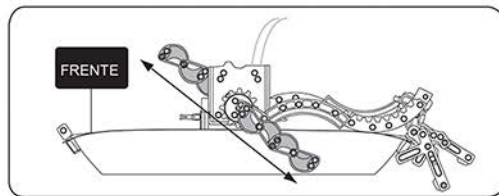
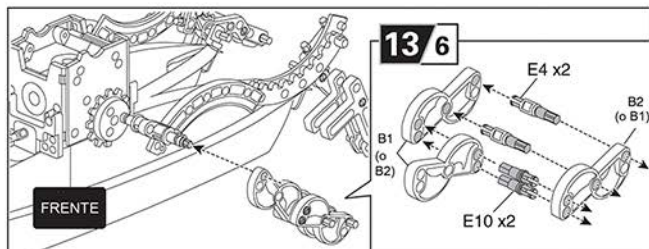

14 Armado del "Rema-bot"

Nivel 2

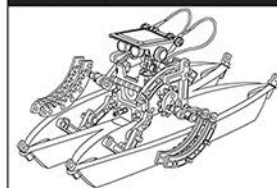

Prepara las partes de abajo antes de armar el "Rema-bot".

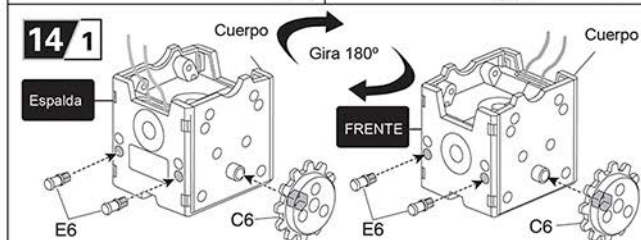
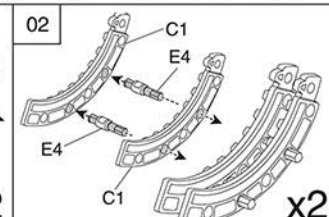
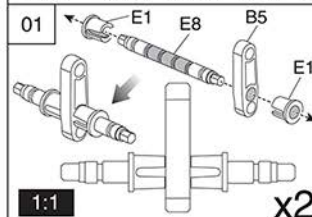
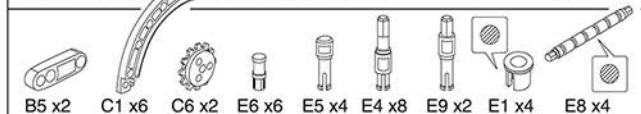
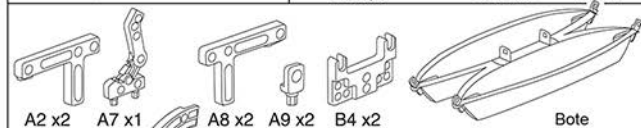

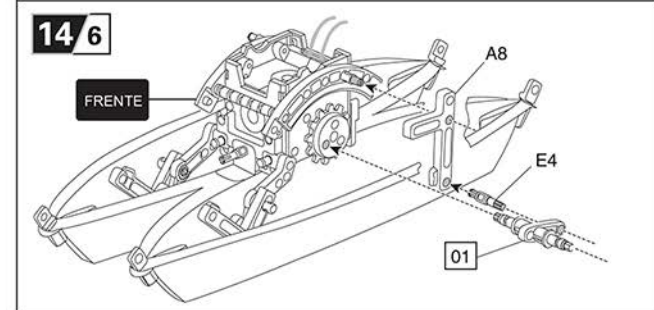
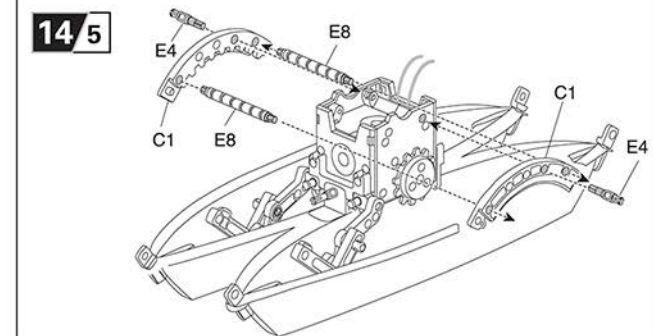
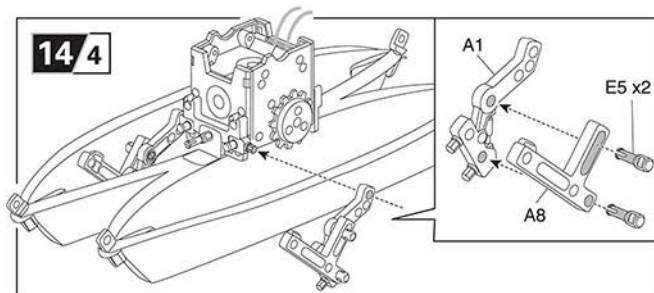
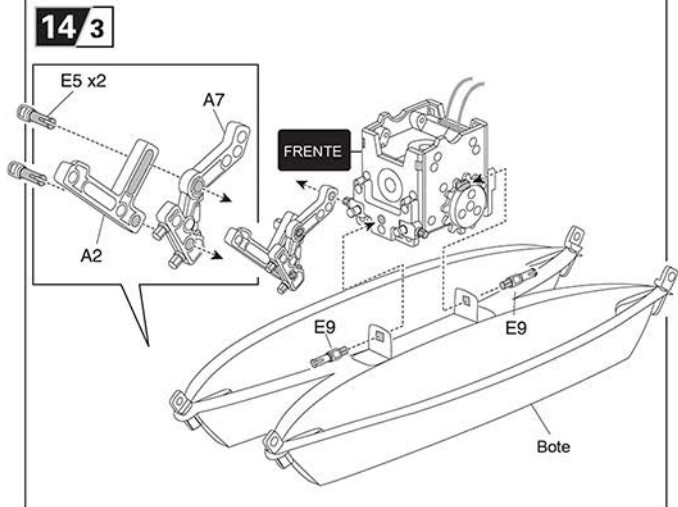
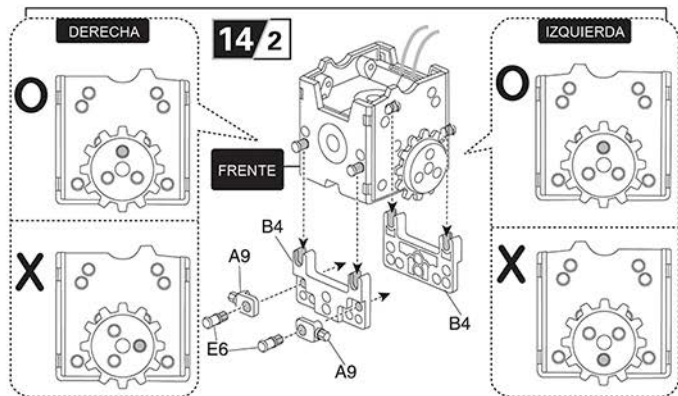

14/7

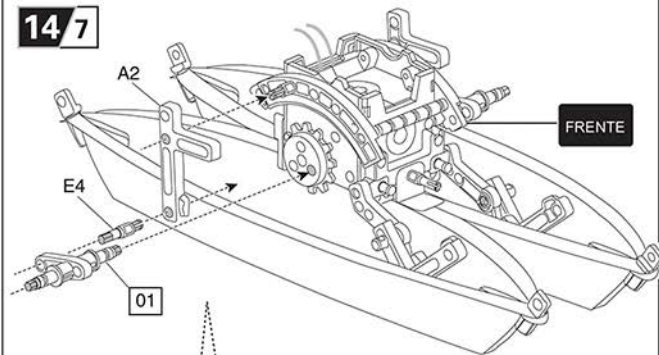

O

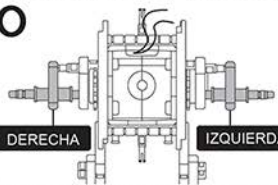

X

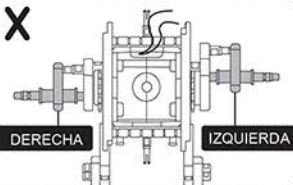

14/8

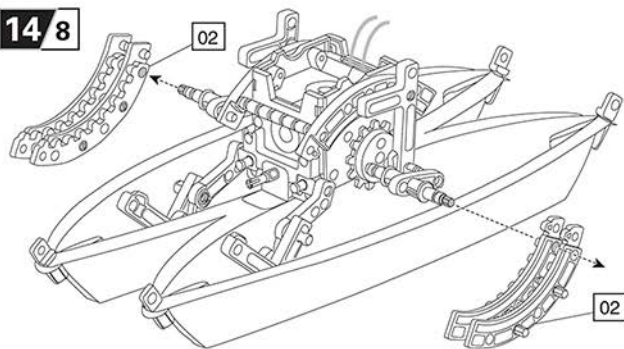

14/9

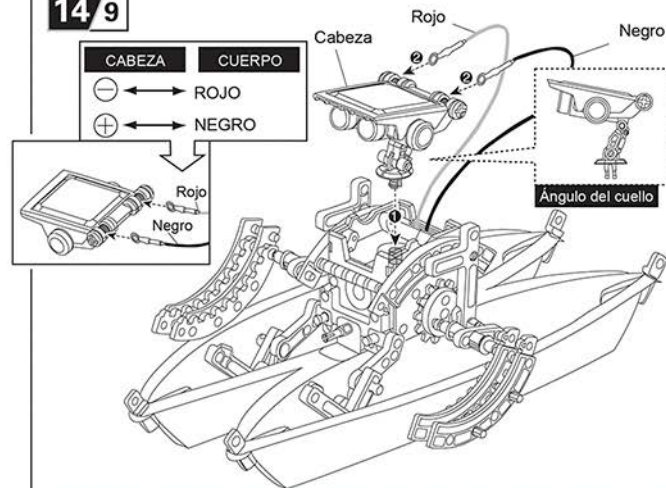

¡Es hora de DIVERTIRSE!



1. Llévelo afuera bajo la luz directa del sol. Funciona mejor cuando lo juegas en un día soleado.
2. Para diversión en interiores, usa un foco de 100 watts de luz de halógeno. Es posible que no funcione correctamente en día nublado, en lugares con sombra, con luz solar indirecta o con luz artificial.

13 en 1 KIT SOLAR ROBÓTICA

Equipo para armar 14 robots diferentes

Importador, Distribuidor, Centro de Atención y Servicio:
ALGARA S.A. de C.V.
Camino Real de Toluca #154,
Col. Bellavista, Deleg. Álvaro Obregón,
C.P. 01140, Ciudad de México.
R.F.C. ALG670404QE3
TEL. 2636 3770 FAX. 55151249
Visítanos en: www.mialegría.com.mx
y escríbenos a: club@mialegría.com.mx

ADVERTENCIA: No recomendado para menores de 36 meses por contener piezas pequeñas. No sumergir. No usar cerca del fuego.



HECHO EN CHINA